

Perfis de Alumínio

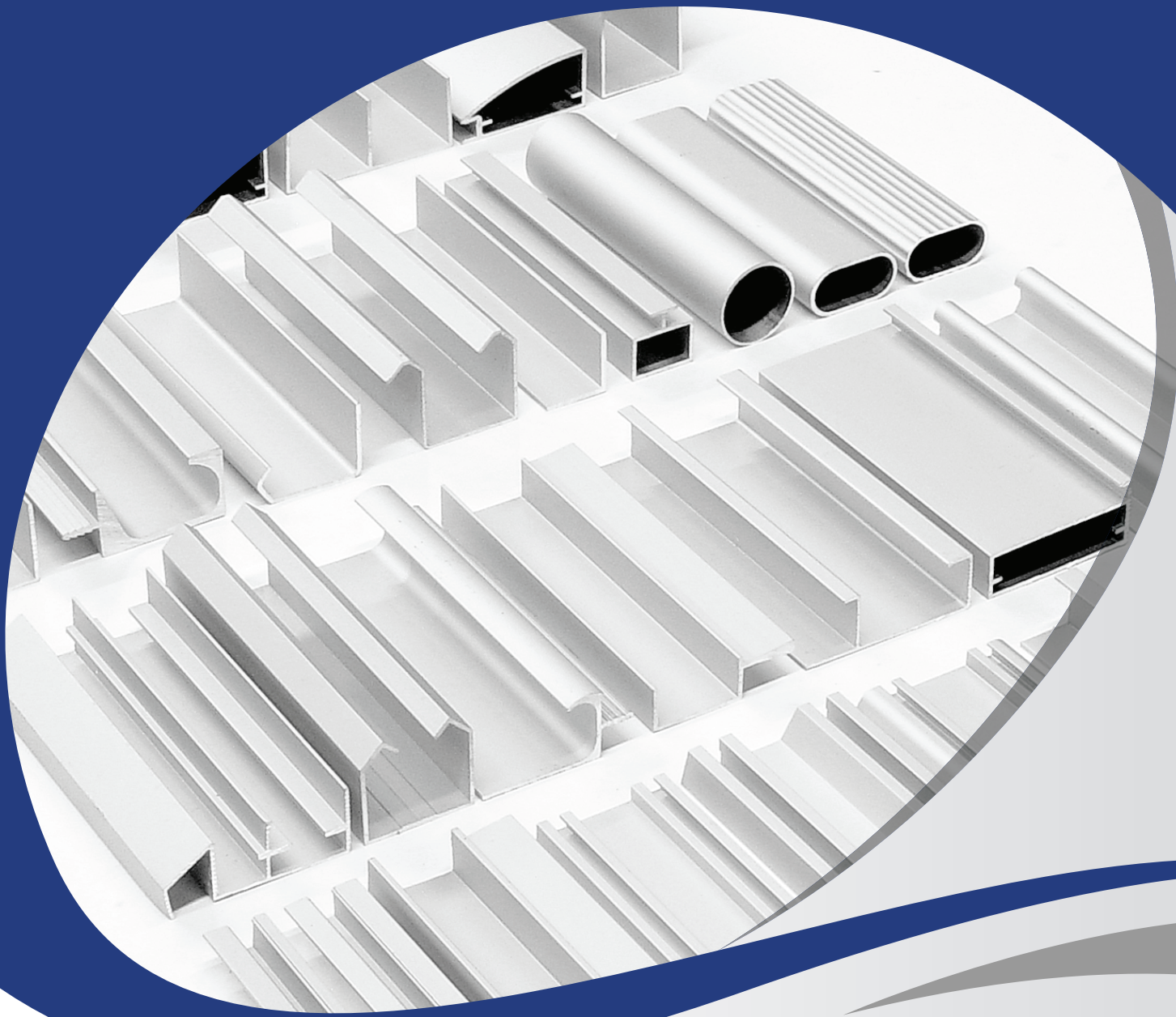

Catálogo

2018

RODINATO[®]
SOLUÇÕES PARA MÓVEIS E ESQUADRIAS

Desde seu início em 1996, a Rodinato procura atender as necessidades do mercado com qualidade e responsabilidade. Pensando nisso, em 2007, iniciou a produção própria de perfis de alumínio.

Com uma infraestrutura qualificada e desde então buscando a excelência em perfis, a Rodinato atende todo mercado nacional fabricando soluções em perfis nas áreas: esquadria de madeira, metálica, alumínio, móveis e diversos.

Desenvolver produtos com qualidade que superem as expectativas dos clientes, buscando a sustentabilidade do negocio

"Ser reconhecida como uma empresa capaz de desenvolver soluções tecnológicas e inovadoras para moveis e esquadrias que atendam as necessidades dos clientes"



- Foco no cliente
 - Ética
- Comprometimento e fidelidade
 - Sustentabilidade
 - Melhoria contínua

ÍNDICE

pag. 04	GRUPO 20 • ESQUADRIA MADEIRA	
		pag. 10
pag. 13	GRUPO 22 • MOVELEIRA	
		pag. 18
pag. 19	GRUPO 24 • TUBOS E VERGALHÕES	
		pag. 22
pag. 23	GRUPO 25 - PERSIANA	
		pag. 24
pag. 25	GRUPO 27 • LINHA DIVISÓRIA	
		pag. 26
pag. 27	GRUPO 29 • LINHA 20/25	
		pag. 35
pag. 37	GRUPO 35 • DIVERSOS	
		pag. 41
pag. 44	GRUPO 37 • LINHA MODULAR	

ACABAMENTOS:

00 - Natural	06 - Pintura GFU
01 - Anodizado Fosco S/Jat.	08 - Anodizado Fosco
02 - Pintura Branco	31 - Anodizado Bronze 1001
03 - Pintura PPR	32 - Pintura Inox

**PERFIS COM OS ACABAMENTOS 01, 08 E 31 CONSULTAR DISPONIBILIDADE DE ESTOQUE NA EMPRESA.*

INSTRUÇÃO PARA CONSULTA DOS CÓDIGOS DOS PERFIS RODINATO

GRUPO + Cód. DO PRODUTO + ACABAMENTO = CÓDIGO DE VENDA

20	01	00	20.01.00
-----------	-----------	-----------	-----------------

GRUPO 20 • ESQUADRIA MADEIRA

20.01.00 - Perfil TR 119 I

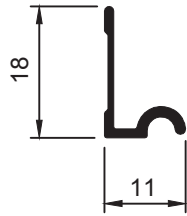

20.02.00 - Perfil TR 120

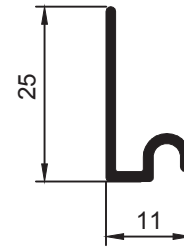

20.03.00 - Perfil TR 119 II

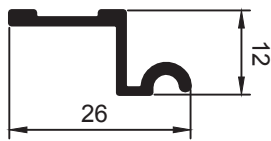

20.04.00 - Perfil TR 119 III

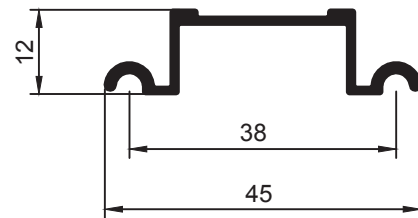

20.05.00 - Perfil TR 3121

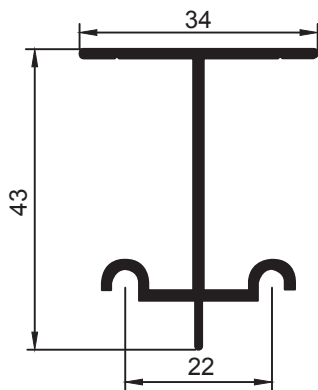

20.06.00 - Perfil TR 130 Leve

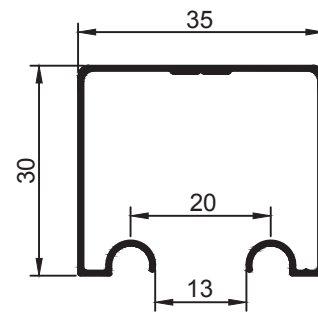

20.07.00 - Perfil TR 130 Pesado

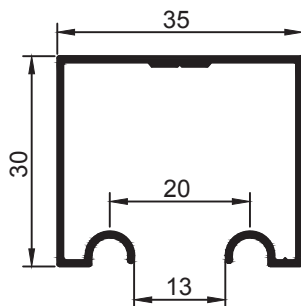

20.08.00 - Perfil TR 135 Leve

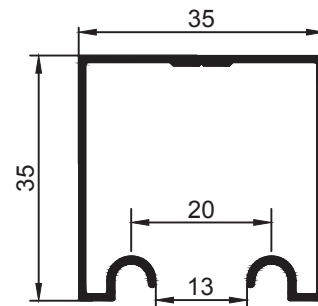

GRUPO 20 • ESQUADRIA MADEIRA

20.09.00 - Perfil TR 135 Pesado

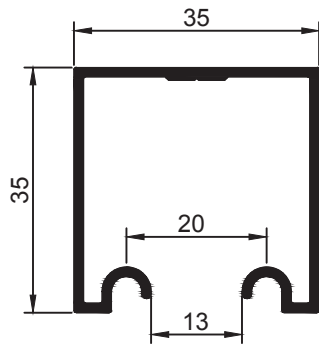

20.10.00 - Perfil TR Gold

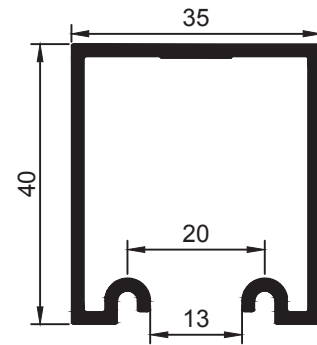

20.11.00 - Perfil TR 114 Leve

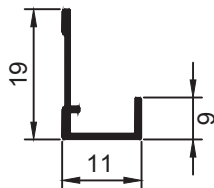

20.12.00 - Perfil TR 114 Pesado

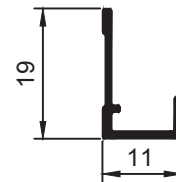

20.13.00 - Perfil TR 3176 Leve

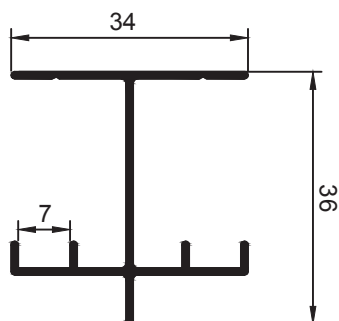

20.14.00 - Perfil TR 3176 Base P/Escova

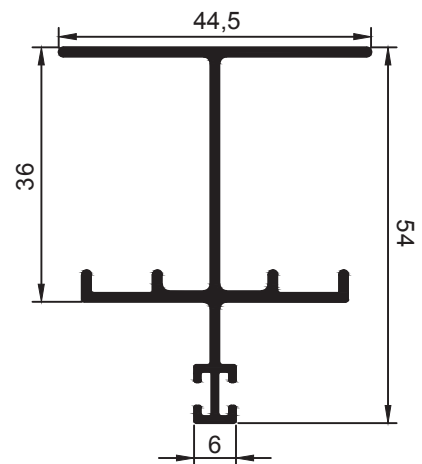

20.15.00 - Perfil Veneza (3045)

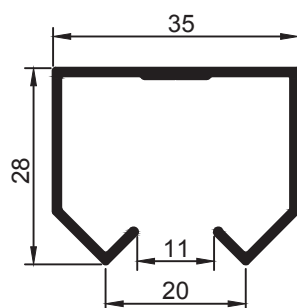

20.16.00 - Perfil Veneza Pesado (3046)

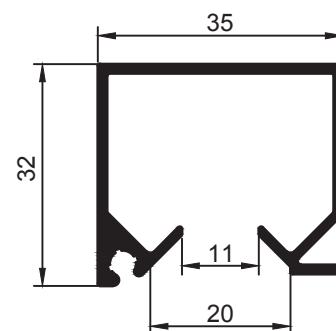

GRUPO 20 • ESQUADRIA MADEIRA

20.17.00 - Perfil Veneza Móveis

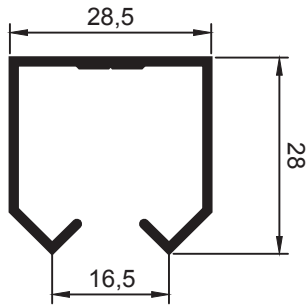

20.18.00 - Perfil TR 200 Veneza 18mm

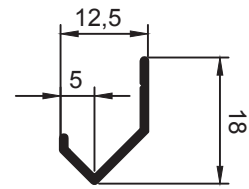

20.19.00 - Perfil TR 202 Veneza II

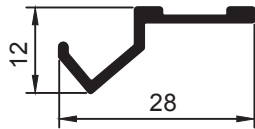

20.20.00 - Perfil TRU 1/2"

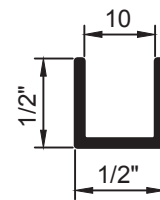

20.21.00 - Perfil TRU 5/8"

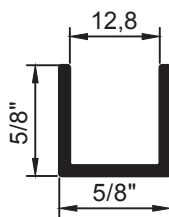

20.22.00 - Perfil TRU 1/2" Litoral

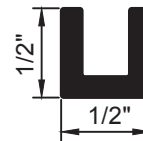

20.23.00 - Perfil Vergalhão Oco 6mm

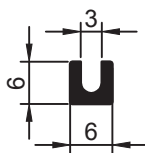

20.24.00 - Perfil Vergalhão Oco 8mm

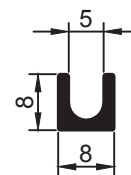

20.25.00 - Perfil Vergalhão Maciço 6mm

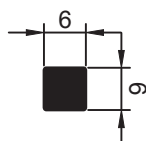

20.26.00 - Perfil Vergalhão Maciço 8mm

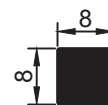

GRUPO 20 • ESQUADRIA MADEIRA

20.27.00 - Perfil Vergalhão Maciço Mod.152

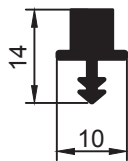

20.28.00 - Perfil Arremate Kit 235

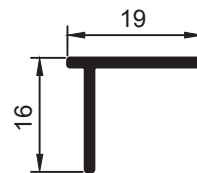

20.29.00 - Perfil Superior Kit 235

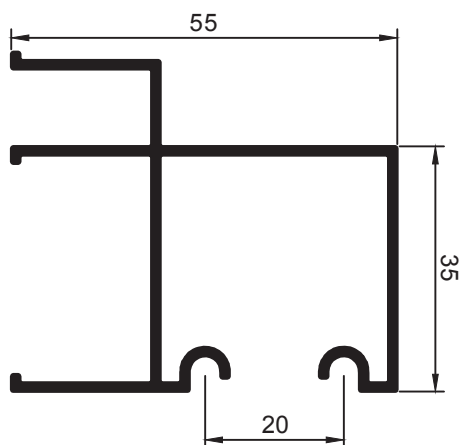

20.30.00 - Perfil Superior Kit Master

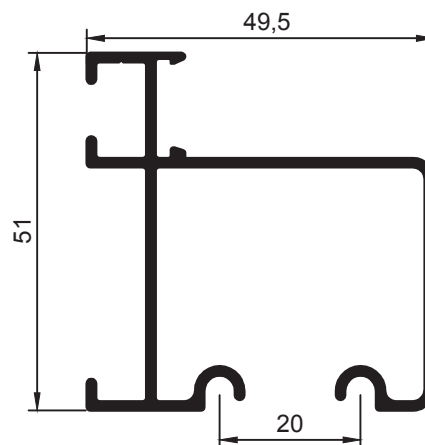

20.31.00 - Perfil Batente Kit Master

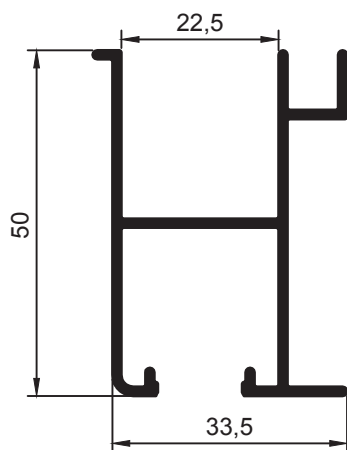

20.32.00 - Perfil Click Kit Master

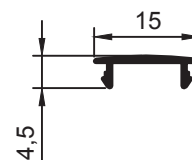

20.33.00 - Perfil Barra Chata Max ar

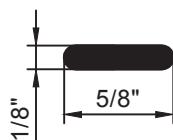

20.34.00 - Perfil Barra Frizada Max ar

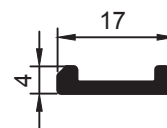

GRUPO 20 • ESQUADRIA MADEIRA

20.35.00 - Perfil Canaleta Max Ar POP

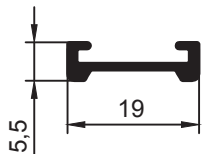

20.36.00 - Perfil Dubai 48x48 Leve

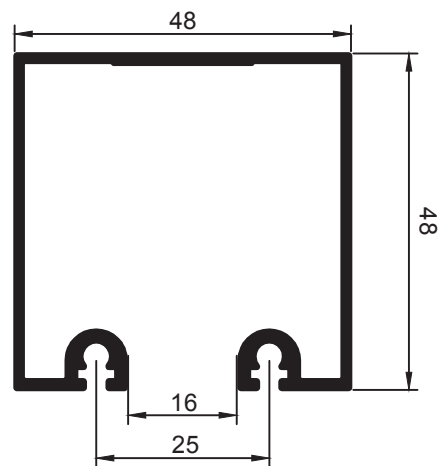

20.37.00 - Perfil Dubai 48x48 Pesado

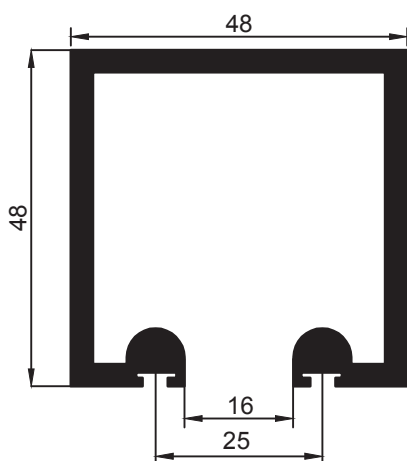

20.38.00 - Perfil 38x38 Chapéu

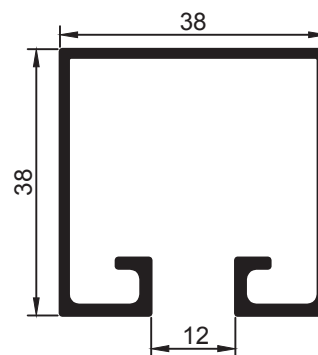

20.39.00 - Perfil Pantográfico

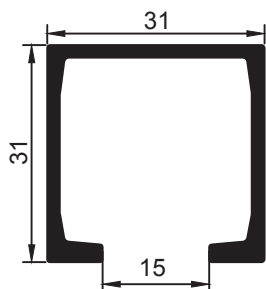

20.40.00 - Perfil Tubo Retangular 10x20

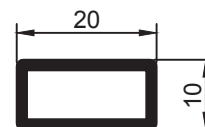

GRUPO 20 • ESQUADRIA MADEIRA

20.41.00 - Perfil Tubo Retangular 10x30

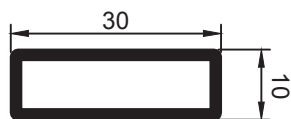

20.42.00 - Perfil TRU 20 mm

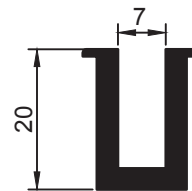

20.44.00 - Perfil 235 Veneza

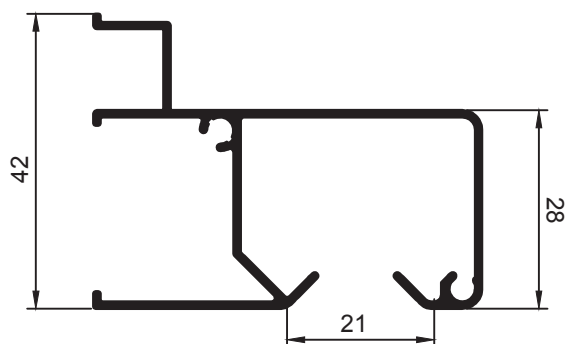

20.45.00 - Perfil TR 3176 Pesado

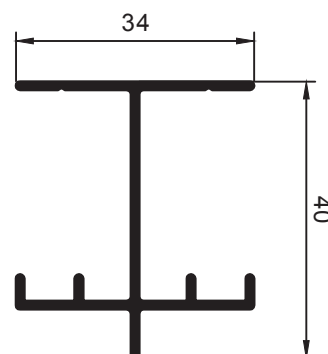

20.46.00 - Perfil TR 152

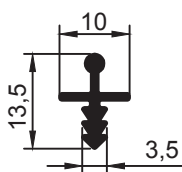

20.47.00 - Perfil TR 3175 Base P/Escova

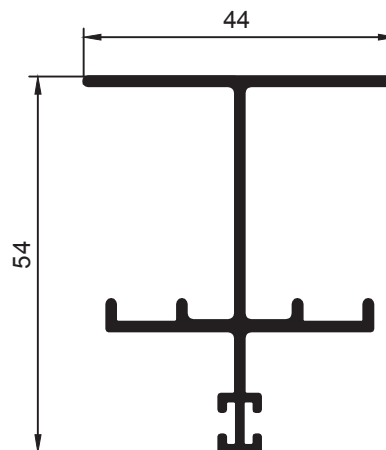

20.48.00 - Perfil TRU 21 x 22,5 mm Guia Dubai

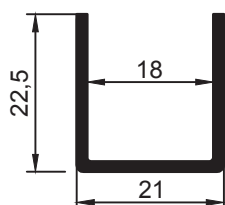

21.01.00 - Perfil KMG 009



21.02.00 - Perfil 009 Aba Simples

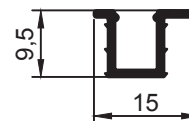

21.03.00 - Perfil 009 Aba Dupla

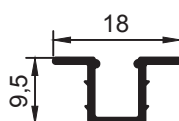

21.04.00 - Perfil KMG Inferior Estreito (3096)

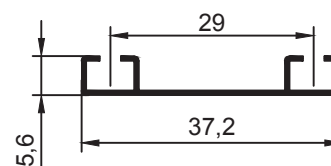

21.05.00 - Perfil KMG Inferior Simples

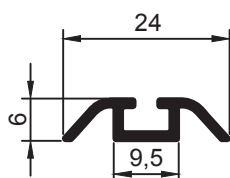

21.06.00 - Perfil KMG Inferior Largo

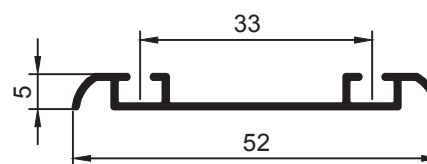

21.07.00 - Perfil KMG Inferior Estreito

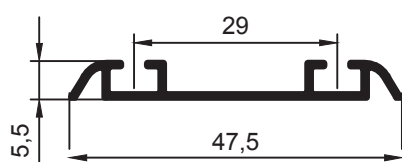

21.08.00 - Perfil Móveis (3129)

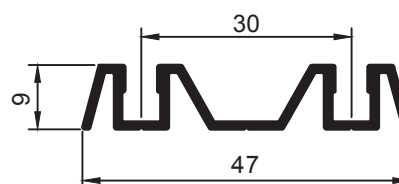

GRUPO 21 • MOVELEIRA

21.09.00 - Perfil KMG Superior S/Aba

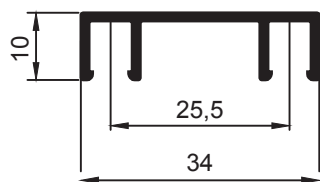

21.10.00 - Perfil KMG Superior C/Aba

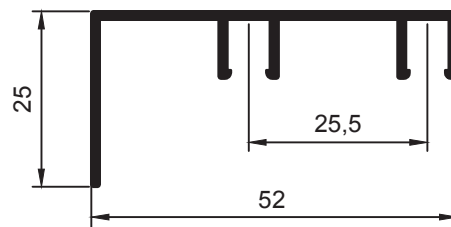

21.11.00 - Perfil KMG Superior Simples

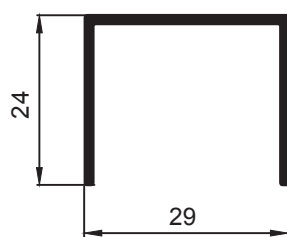

21.12.00 - Perfil KMG Superior Duplo

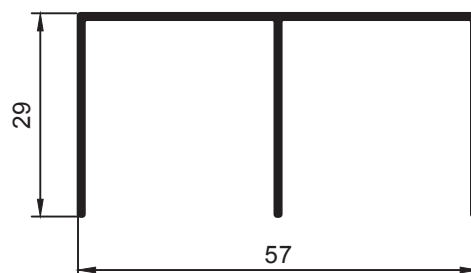

21.13.00 - Perfil KMG Sup. Duplo Largo

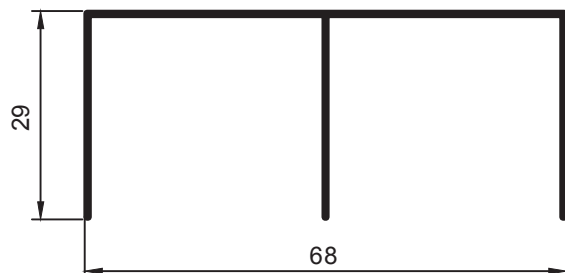

21.14.00 - Perfil Rodimobile

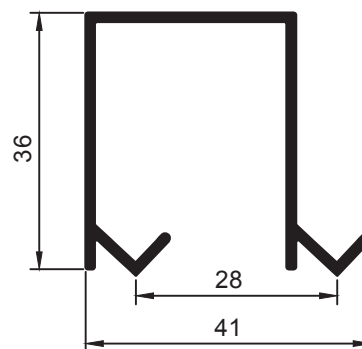

21.15.00 - Perfil Rodiveneza Simples

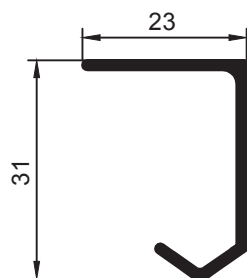

21.16.00 - Perfil Rodiveneza Duplo I

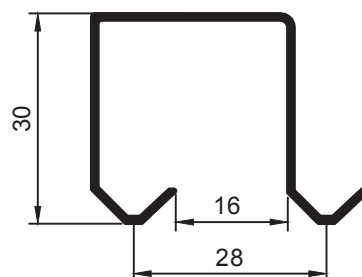

GRUPO 21 • MOVELEIRA

21.17.00 - Perfil Rodiveneza Duplo II

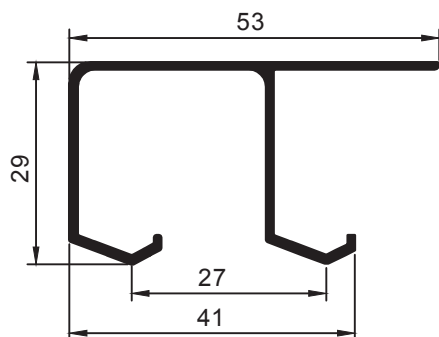

21.18.00 - Perfil GFP Duplo

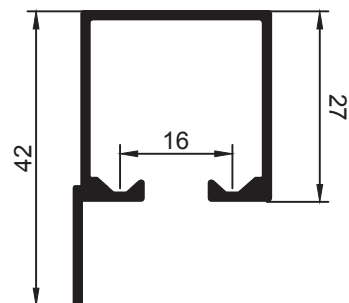

21.19.00 - Perfil Móveis RD 01

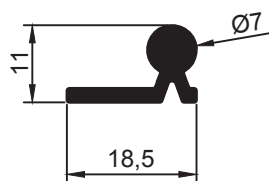

21.20.00 - Perfil Móveis RD 02

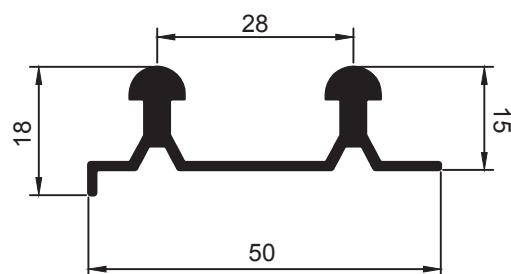

21.21.00 - Perfil Móveis RD 03

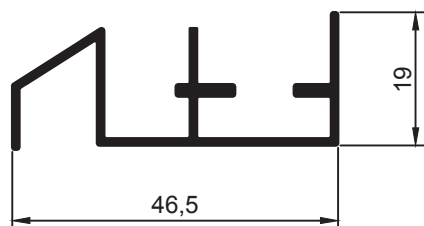

21.22.00 - Perfil Móbile Sobrepor 29mm

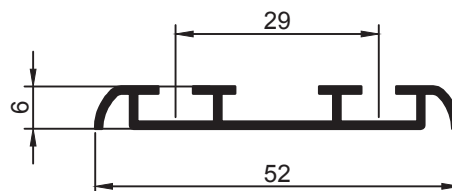

21.23.00 - Perfil Móbile Sobrepor 33mm

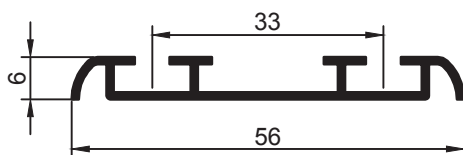

21.24.00 - Perfil KMG Inferior Largo (3096)

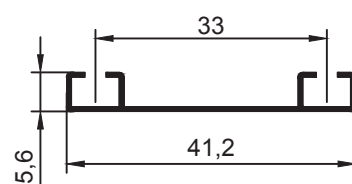

21.25.00 - Perfil Móveis KMG Lateral

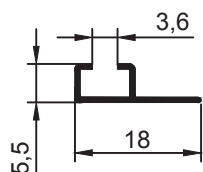

22.01.00 - Perfil Arremate de Encaixe 15mm

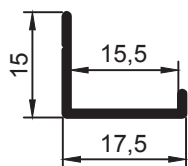

22.02.00 - Perfil Arremate de Encaixe 18mm

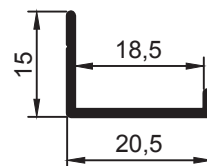

22.03.00 - Perfil Arremate de Espiga 15mm

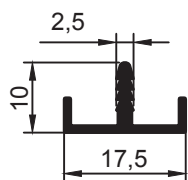

22.04.00 - Perfil Arremate de Espiga 18mm

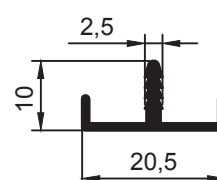

22.05.00 - Perfil Arremate de Espiga 20mm

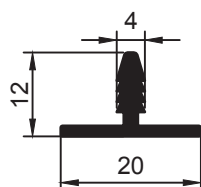

22.06.00 - Perfil Acabamento Central

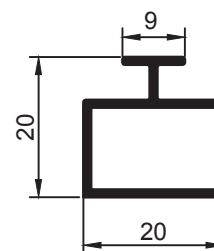

22.07.00 - Perfil Puxador de Encaixe 15mm Leve

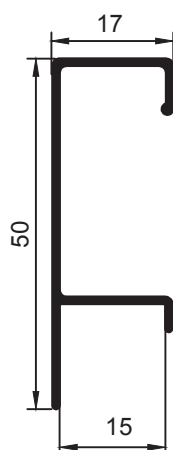

22.08.00 - Perfil Puxador de Encaixe 15mm Normal



22.09.00 - Perfil Puxador de Encaixe 15mm Pesado

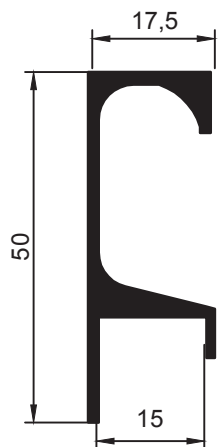

22.10.00 - Perfil Puxador de Encaixe 18mm

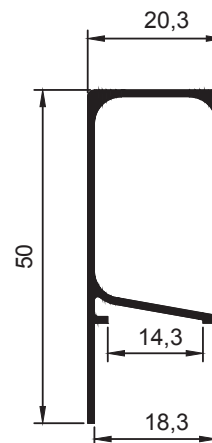

22.11.00 - Perfil Puxador C/Aba 20mm

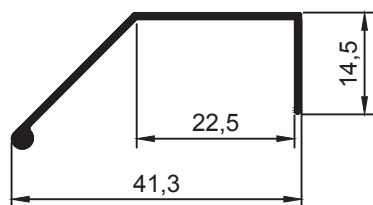

22.12.00 - Perfil Puxador de Cozinha Peq.

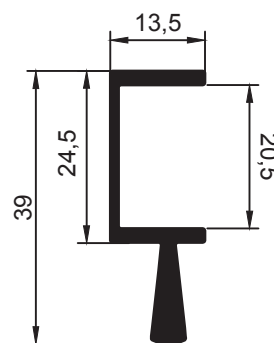

22.13.00 - Perfil Puxador de Cozinha Gr

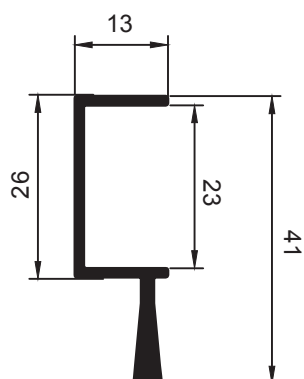

22.14.00 - Perfil Puxador C/Acab.18mm

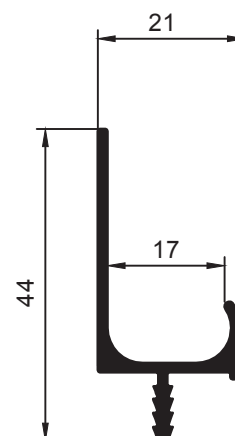

22.15.00 - Perfil Puxador Espiga 15mm

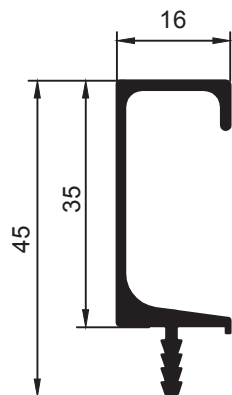

22.16.00 - Perfil Puxador Espiga 18mm

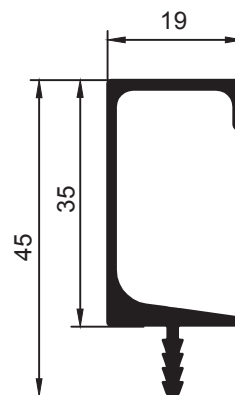

22.17.00 - Perfil Puxador Espiga 20mm

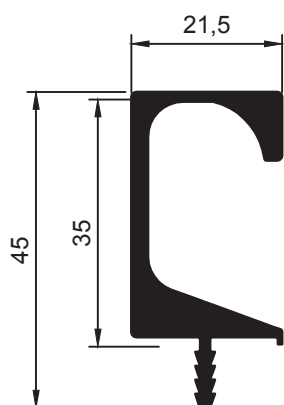

22.29.00 - Perfil Puxador BF 15mm

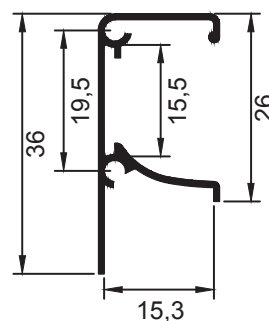

22.33.00 - Perfil Puxador BF 18mm

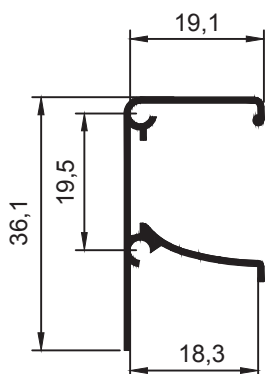

22.30.00 - Perfil Puxador com Abas Móveis

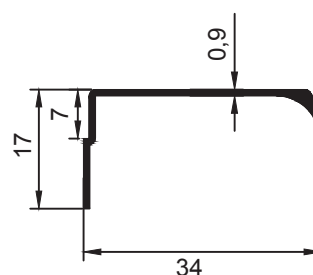

22.31.00 - Perfil Puxador com Tampa 15mm

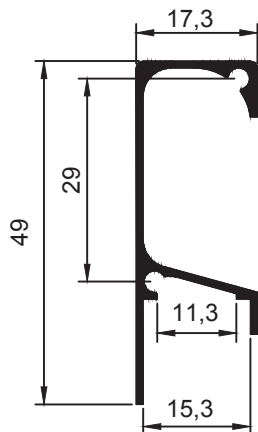

22.32.00 - Perfil Puxador com Tampa 18mm

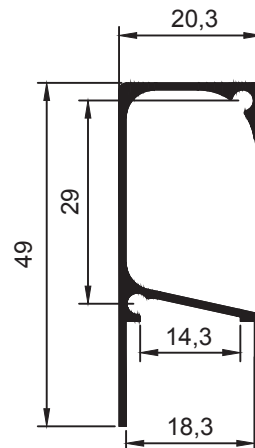

22.18.00 - Perfil Puxador Batente 15mm

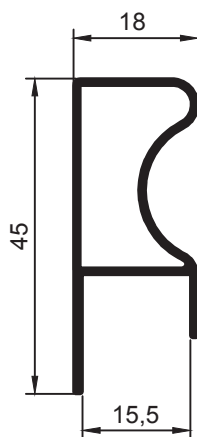

22.19.00 - Perfil Puxador Batente 3141

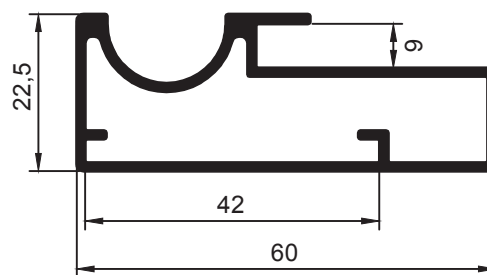

22.20.00 - Perfil Puxador Batente 3218

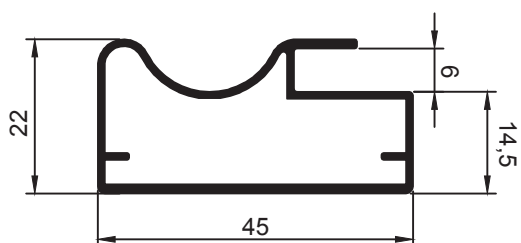

22.21.00 - Perfil Batente 3145

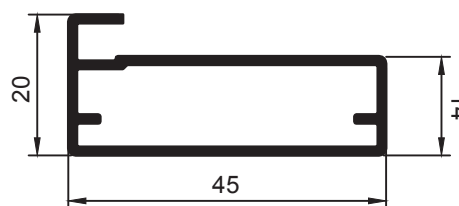

GRUPO 22 • MOVELEIRA

22.22.00 - Perfil Batente 3139

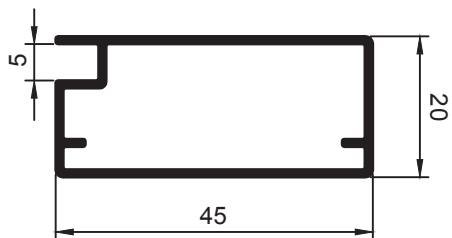

22.23.00 - Perfil Batente 3140

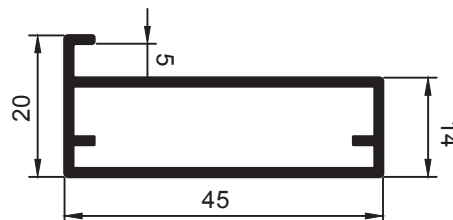

22.24.00 - Perfil Batente 3142



22.25.00 - Perfil Batente 3143

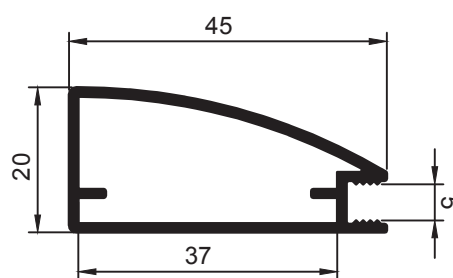

22.26.00 - Perfil Batente 3144

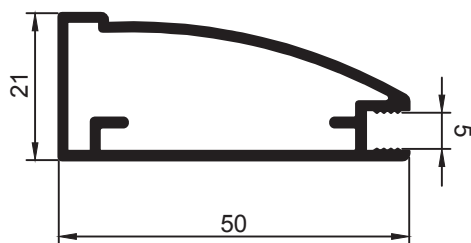

22.27.00 - Perfil Gota

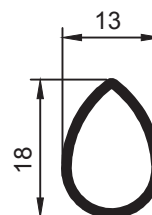

22.28.00 - Perfil Bota

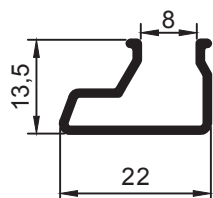

Perfil Barra Chata

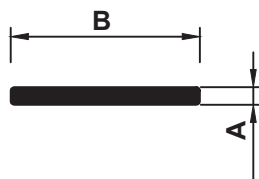

CÓDIGO	MILIMETROS	
	A	B
23.01.00	3/16"	1/2"
23.02.00	1/8"	3/4"
23.03.00	2,5	27
23.04.00	3,5	100

Perfil Cantoneira

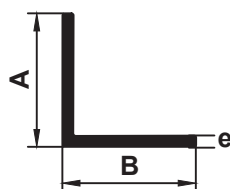

CÓDIGO	MILIMETROS		
	A	B	e
23.11.00	3/8"	3/8"	1,58
23.12.00	5/8"	5/8"	1,58
23.13.00	3/4"	3/4"	1,58
23.14.00	1"	1"	2
23.15.00	13/16"	13/16"	2
23.16.00	1 1/2"	1 1/2"	2,5
23.17.00	2"	2"	2,5
23.18.00	15	5	0,8
23.19.00	3/4"	1"	2
23.20.00	25	81	2,5
23.21.00	1"	1"	0,7
23.22.00	3/4"	3/4"	0,7
23.23.00	5/8"	5/8"	0,7
23.24.00	1/2"	1/2"	0,7

GRUPO 24 • TUBOS E VERGALHÕES

24.01.00 - Tubo Redondo 1/2"



24.02.00 - Tubo Redondo 5/8"



24.03.00 - Tubo Cabideiro Redondo 1"

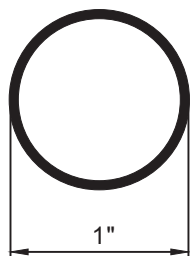

24.04.00 - Tubo Redondo Estriado 7/8" P/Rodo



24.05.00 - Tubo Redondo 3/8" Parede de 2,2mm



24.06.00 - Tubo Cabideiro Oblongo

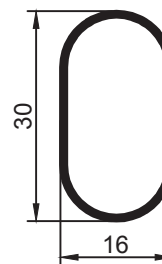

24.07.00 - Tubo Cabideiro Oblongo Estriado

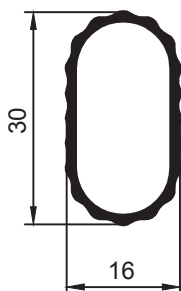

24.19.00 - Perfil Cabideiro 13.5-28

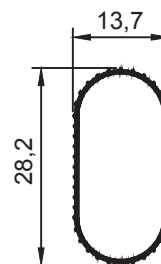

24.20.00 - Perfil Cabideiro 15-19.5

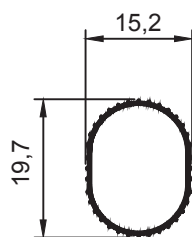

24.21.00 - Perfil Tubo 1 1/4" Parede 1mm

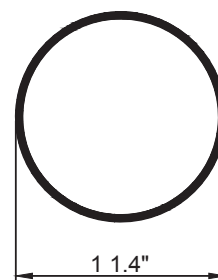

GRUPO 24 • TUBOS E VERGALHÕES

24.22.00 - Perfil Tubo 5/16" Parede 1,35mm

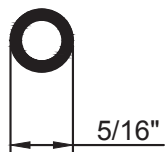

24.24.00 - Perfil Tubo 5/8" Parede 2,5mm



Vergalhão Redondo



CÓDIGO	MILIMETROS
	A
24.08.00	5/16"
24.09.00	3/8"
24.10.00	7/16"
24.11.00	15/32"
24.23.00	1/4"

Tubo Quadrado

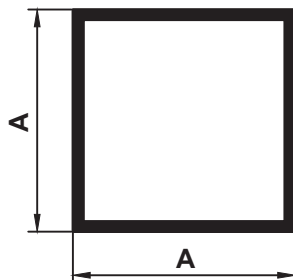

CÓDIGO	MILIMETROS
	A
24.12.00	3/8"
24.13.00	1/2"
24.14.00	1 1/4"
24.15.00	2"
24.16.00	1 1/4"

GRUPO 24 • TUBOS E VERGALHÕES

24.17.00 - Régua de Pedreiro Leve

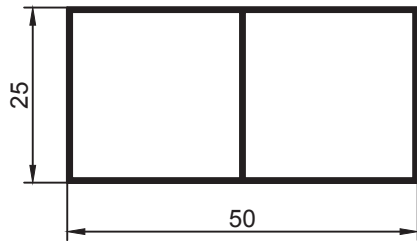

24.18.00 - Régua de Pedreiro Pesada

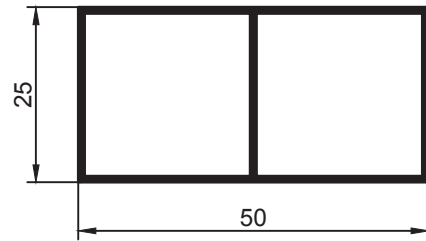

GRUPO 25 • CORTINA

25.01.00 - Perfil Cortina Simples

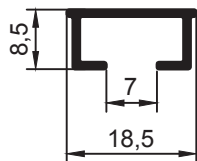

25.10.00 - Perfil Cortina Simples c/ Aba

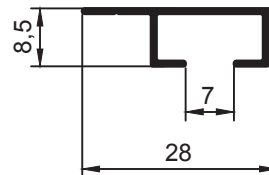

25.02.00 - Perfil Cortina Duplo

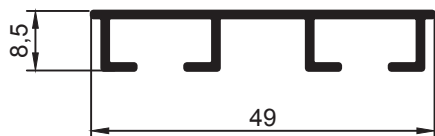

25.03.00 - Perfil Cortina Triplo



25.04.00 - Perfil Cortina Triplo c/ Gara

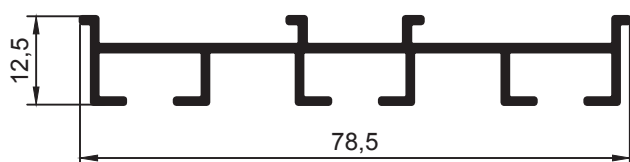

25.05.00 - Perfil Cortina Simples c/ Sanca

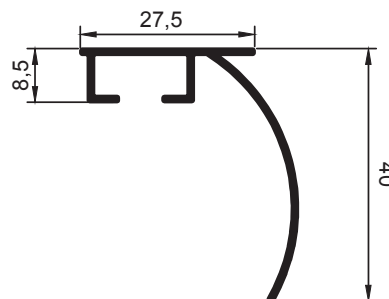

25.06.00 - Perfil Cortina Duplo c/ Sanca

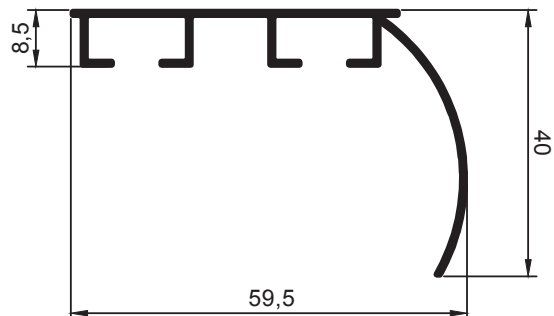

25.11.00 - Perfil Cortina Wave C/Aba Natural

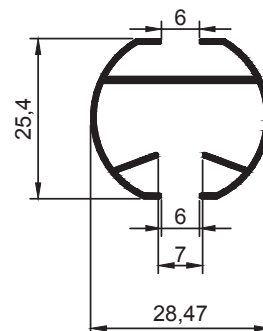

25.12.00 - Perfil Cortina Wave S/Aba Natural

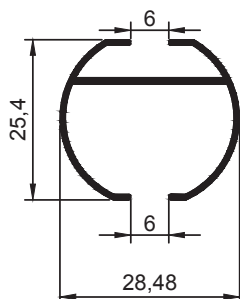

GRUPO 25 • PERSIANA

25.07.00 - Perfil Persiana Bandô

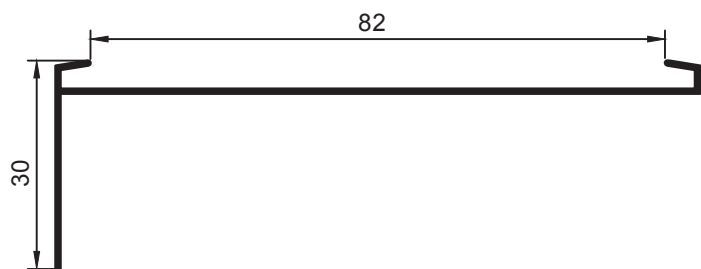

25.08.00 - Perfil Persiana Eixo

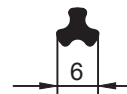

25.09.00 - Perfil Persiana Superior Carrinho

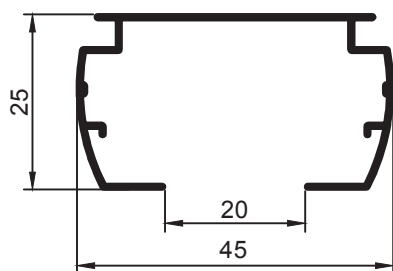

GRUPO 26 • VIDRO / ALUMÍNIO

26.01.00 - Perfil Inf.P/Janela Vidro Temperado

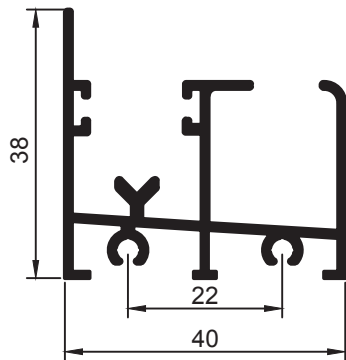

26.02.00 - Perfil Sup.P/Janela Vidro Temperado

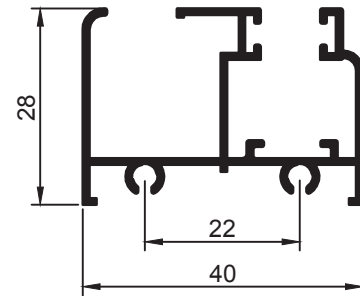

26.03.00 - Perfil Lateral P/Janela Vidro Temperado

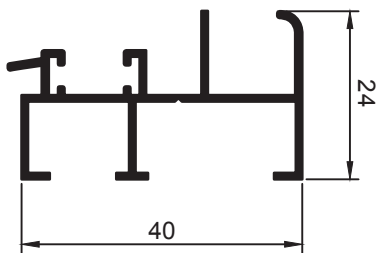

26.04.00 - Perfil Suporte Vidro/Carrinho

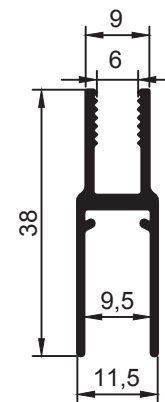

26.05.00 - Perfil Suporte Fixo Vidro

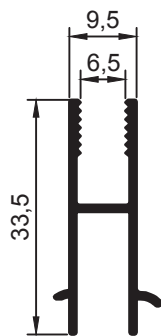

26.06.00 - Perfil Mata Junta Central

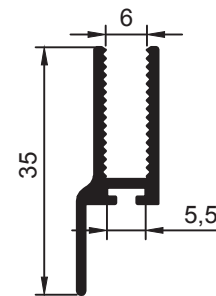

26.07.00 - Perfil Mão Amiga

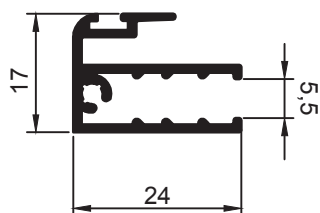

26.08.00 - Perfil Click P/Janela Vidro Temperado

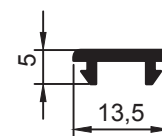

GRUPO 27 • LINHA DIVISÓRIA

27.01.00 - Perfil Batente P/Divisória

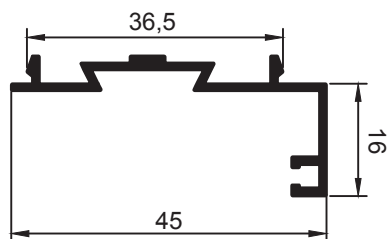

27.02.00 - Perfil Bagueete P/Divisória

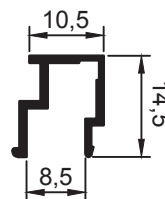

27.03.00 - Perfil Porta e Bagueete P/Divisória

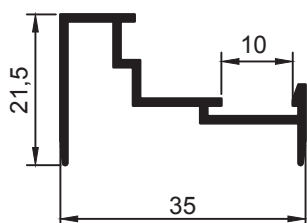

27.04.00 - Perfil Guia U P/Divisória

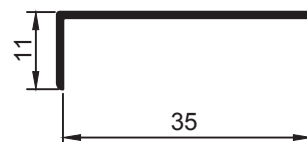

27.05.00 - Perfil Travessa/Guia

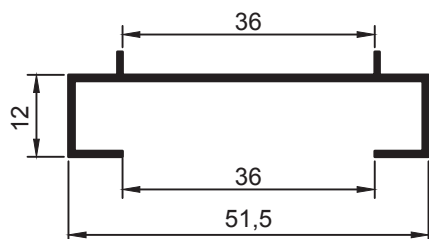

27.06.00 - Perfil Travessa H P/Divisória

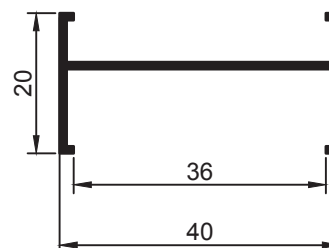

GRUPO 28 • LINHA 16

28.01.00 - Perfil 002

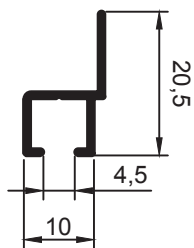

28.02.00 - Perfil 038

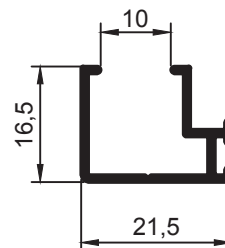

28.03.00 - Perfil 018

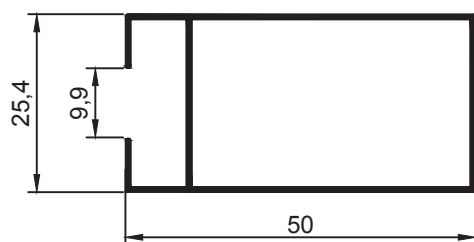

28.04.00 - Perfil 021

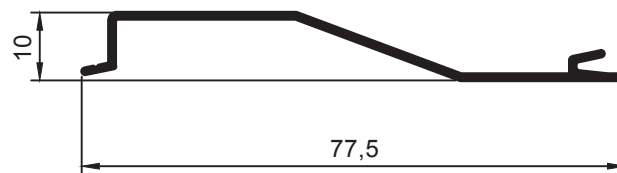

28.05.00 - Perfil 017

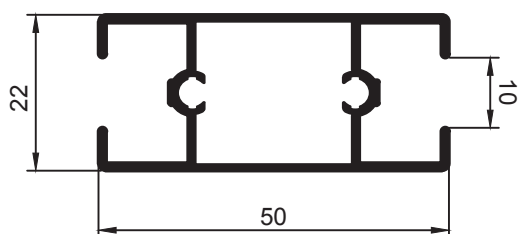

28.06.00 - Perfil 025

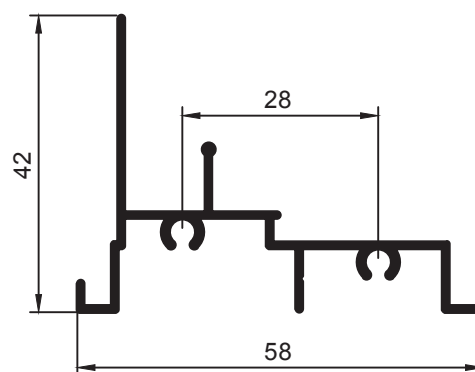

28.07.00 - Perfil 020

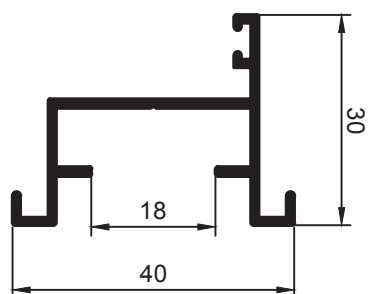

28.08.00 - Perfil 008

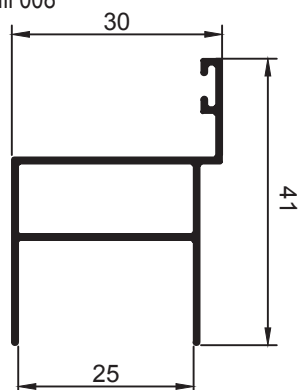

29.16.00 - Perfil Requadro Inferior Max-Ar S/Grade

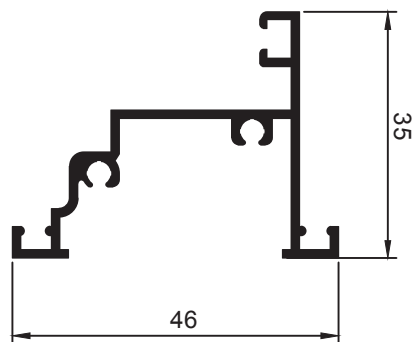

29.37.00 - Perfil Requadro Superior Max-Ar C/Grade

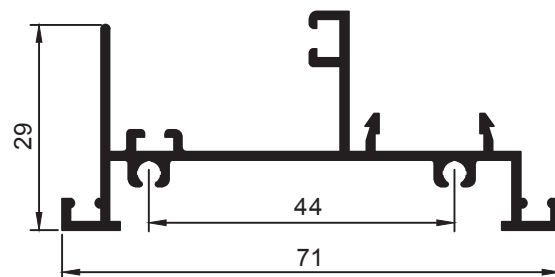

29.38.00 - Perfil Requadro Lateral Max-Ar C/Grade

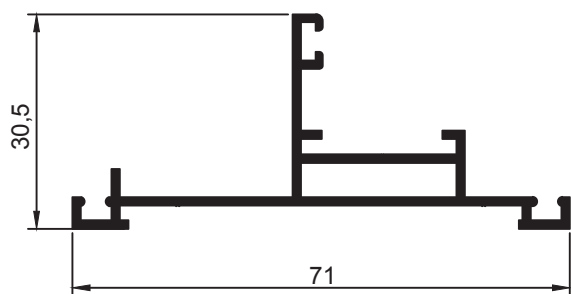

29.39.00 - Perfil Requadro Inferior Max-Ar C/Grade

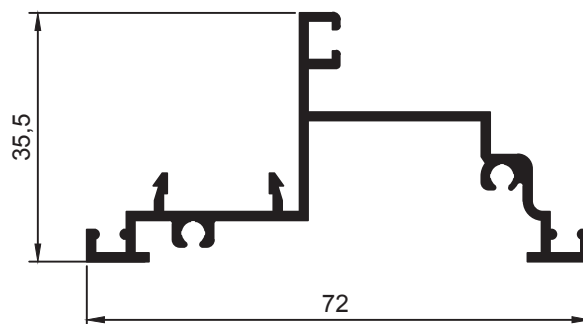

29.40.00 - Perfil Cadeirinha Inferior Max-Ar

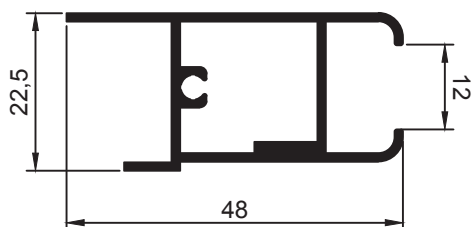

29.41.00 - Perfil Cadeirinha Superior Max-Ar

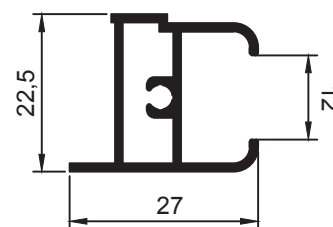

29.42.00 - Perfil Cadeirinha Lateral Max-Ar

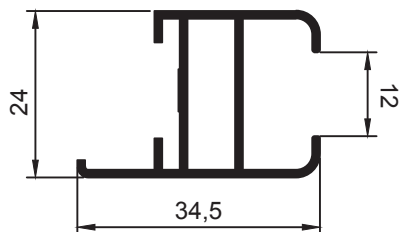

29.48.00 - Perfil Requadro Superior Max-Ar S/Grade

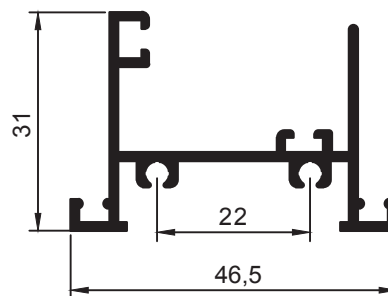

29.58.00 - Perfil Travessa Vertical Max-Ar 02 Secção

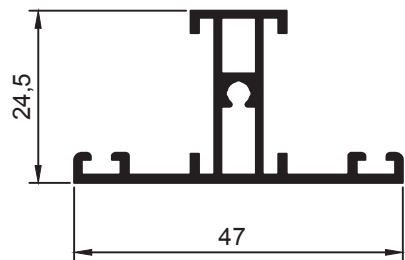

29.12.00 - Perfil Requadro Lateral Max-Ar S/Grade

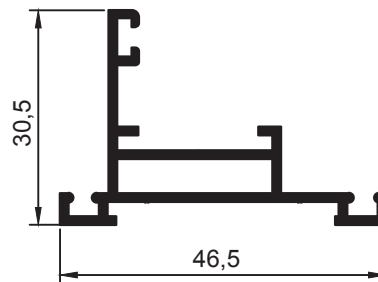

29.02.00 - Perfil Cadeirinha Mão Amiga Porta Correr

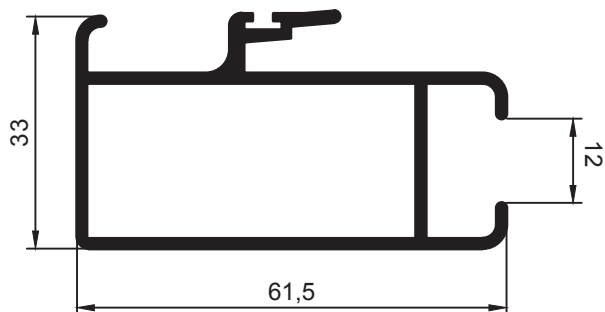

29.03.00 - Perfil Cadeirinha Mata Junta Porta Correr

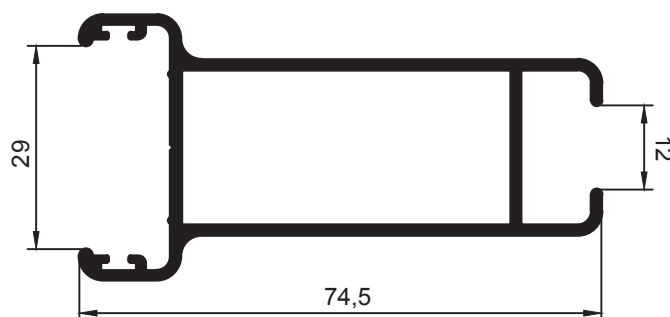

29.05.00 - Perfil Travessa Superior Porta Correr

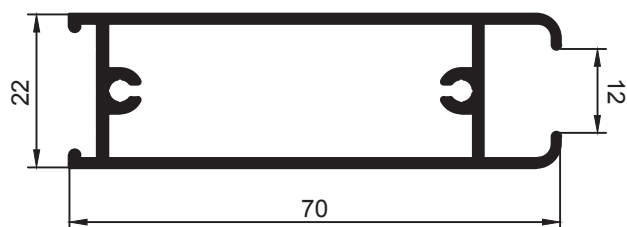

29.07.00 - Perfil Trilho Superior Porta Correr

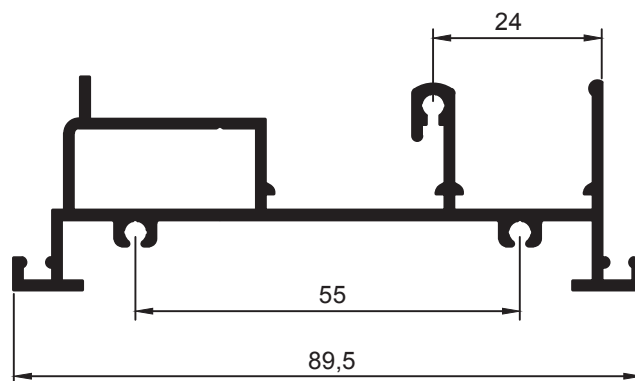

29.08.00 - Perfil Trilho Inferior Porta Correr

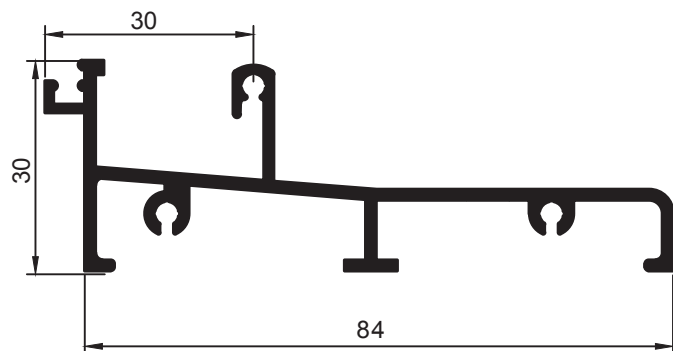

29.09.00 - Perfil Travessa Inferior Porta Correr

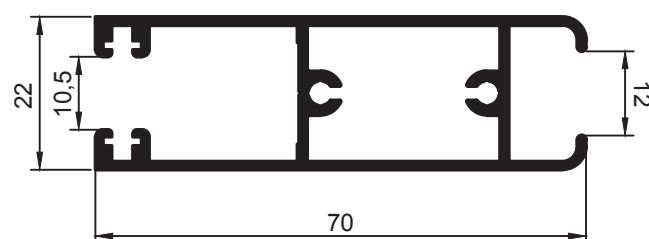

29.10.00 - Perfil Requadro Lateral Porta Correr

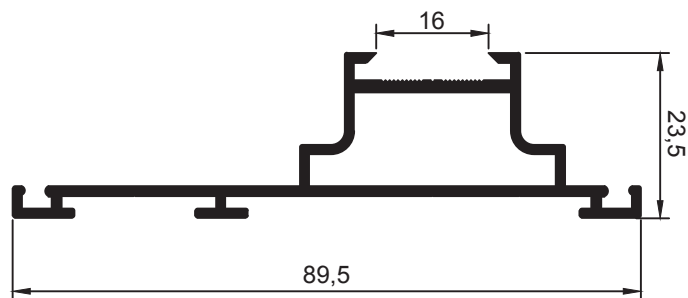

29.53.00 - Perfil Contra testa Porta Correr

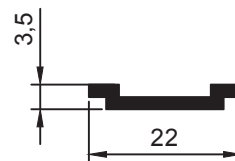

29.56.00 - Perfil Requadro Lateral Porta Correr



29.06.00 - Perfil Travessa Intermediaria Porta Abrir

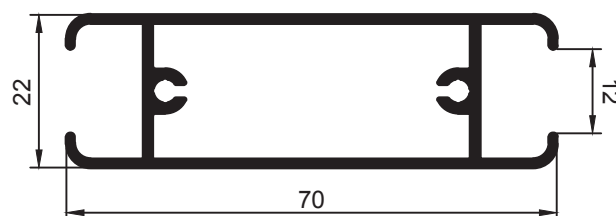

29.17.00 - Perfil Cadeirinha Porta Abrir



29.28.00 - Perfil Batente

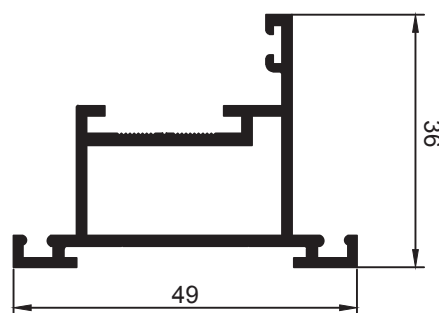

29.43.00 - Perfil Travessa Caderinha Porta

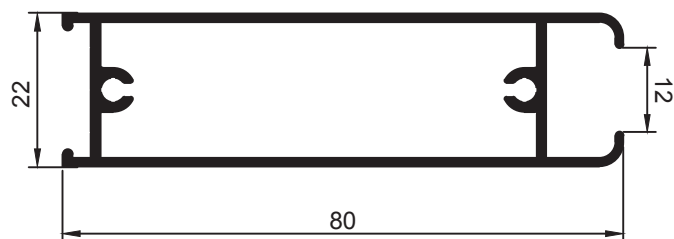

29.46.00 - Perfil Travessa Batente Porta

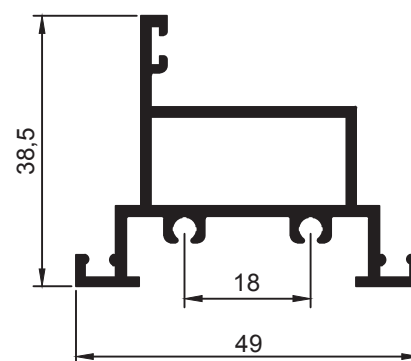

29.49.00 - Perfil Trava da Porta



29.54.00 - Perfil Travessa intermediária Abrir

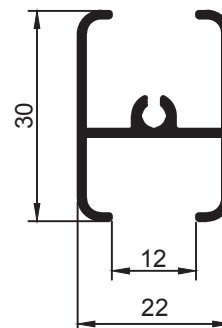

29.01.00 - Perfil Cadeirinha Porta Lambri



29.04.00 - Perfil Travessa Cadeirinha Porta Lambri

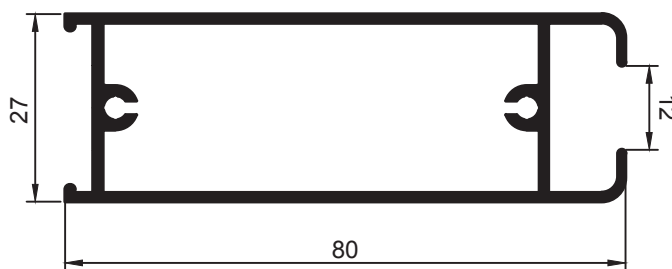

29.13.00 - Perfil Travessa Batente Porta Lambri

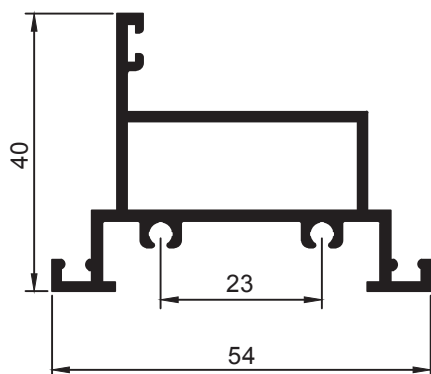

29.55.00 - Perfil Batente Porta Lambri

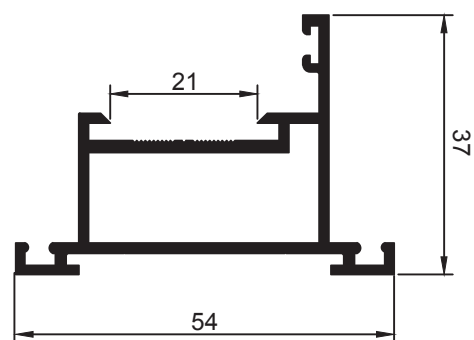

29.14.00 - Perfil Trilho Superior Veneziana Lateral

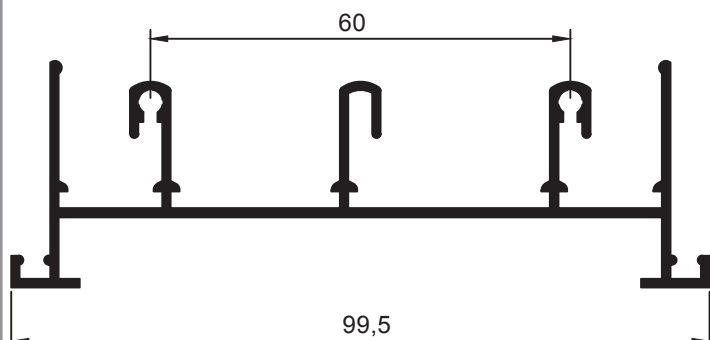

29.15.00 - Perfil Trilho Inferior Veneziana Lateral

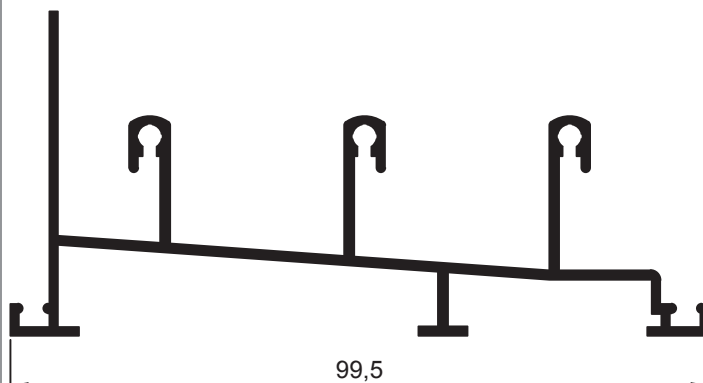

29.18.00 - Perfil Cadeirinha Abafador Vitro/Veneziana Central

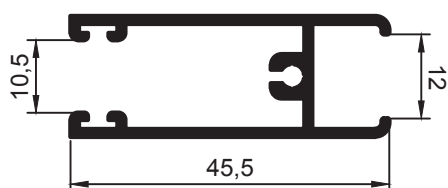

29.19.00 - Perfil Cadeirinha Abafador Vitro/Veneziana Central

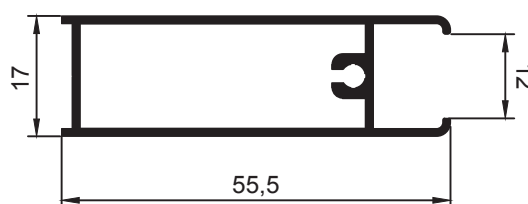

29.21.00 - Perfil Requadro Lateral Veneziana Lateral

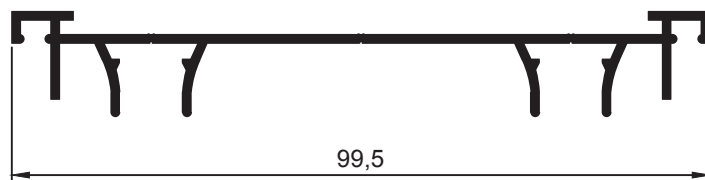

29.22.00 - Perfil Requadro Lateral Vitro e Veneziana

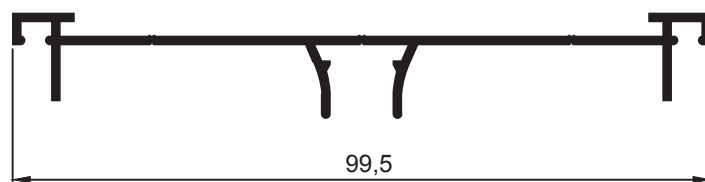

29.23.00 - Perfil Requadro Lateral Vitro Lateral C/Grade

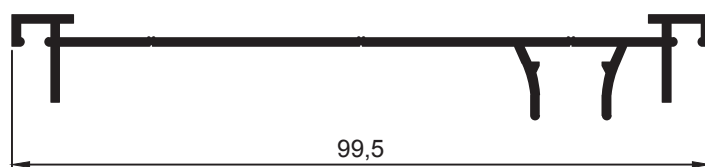

29.24.00 - Perfil Mata Junta Movel Vitro e Veneziana

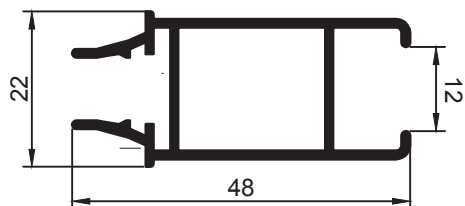

29.25.00 - Perfil Mata Junta Abafador Vitro e Veneziana

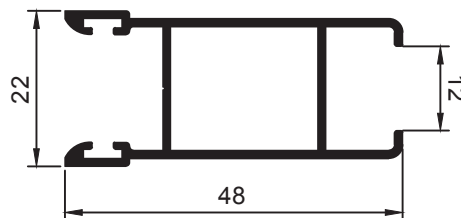

29.26.00 - Perfil Mão Amiga Vitro e Veneziana Central

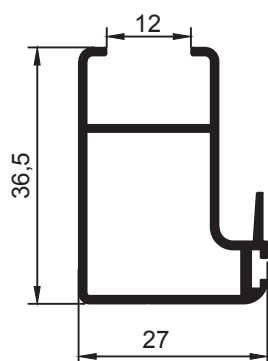

29.27.00 - Perfil Mão Amiga Dupla Fixa Veneziana Central

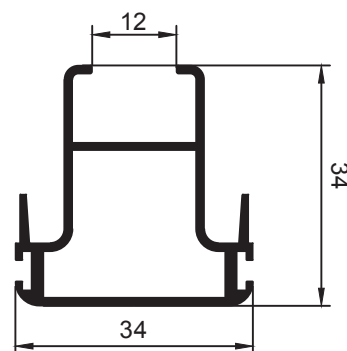

29.29.00 - Perfil Trilho Inferior Vitro Central C/Grade

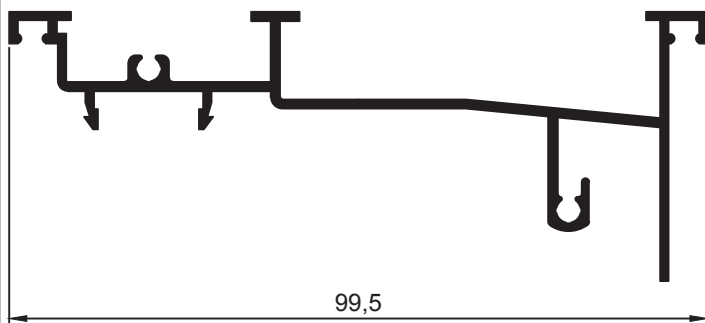

29.30.00 - Perfil Trilho Superior Vitro Central C/Grade

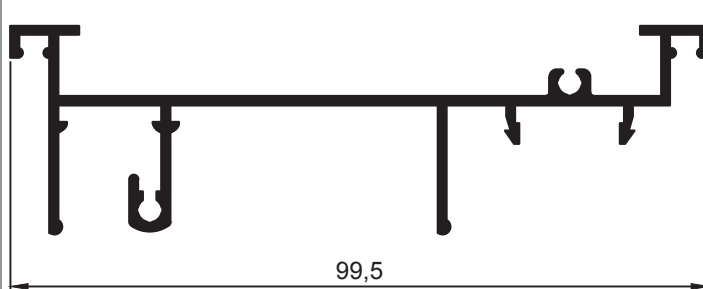

29.31.00 - Perfil Requadro Lateral Vitro S/Grade

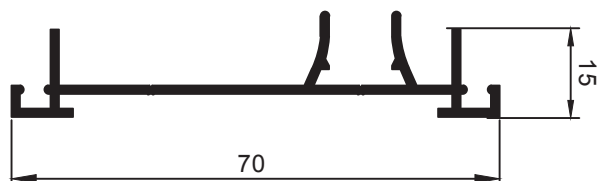

29.32.00 - Perfil Trilho Superior Vitro Lateral S/Grade

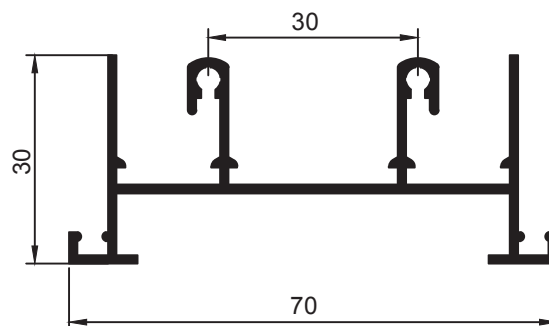

29.33.00 - Perfil Trilho Inferior Vitrô Lateral S/Grade

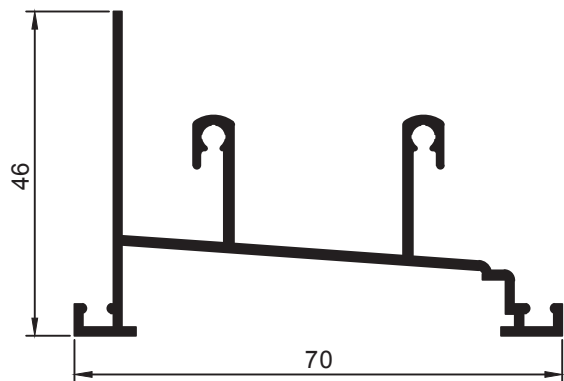

29.34.00 - Perfil Trilho Superior Vitrô Central S/Grade

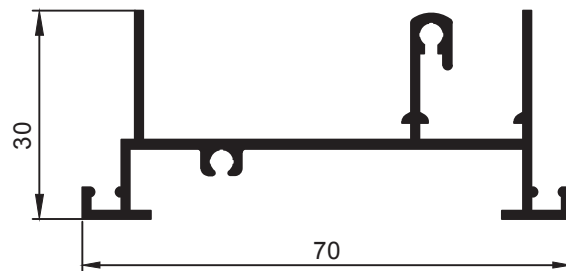

29.35.00 - Perfil Trilho Inferior Vitrô Central S/Grade

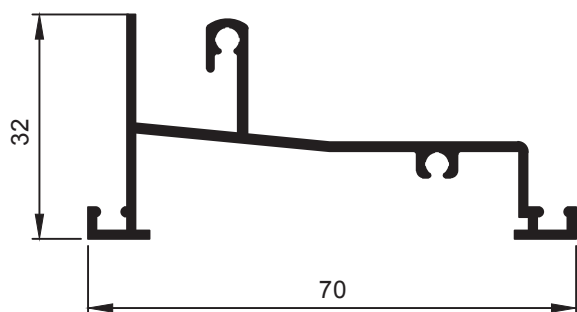

29.44.00 - Perfil Trilho Inferior Veneziana Central

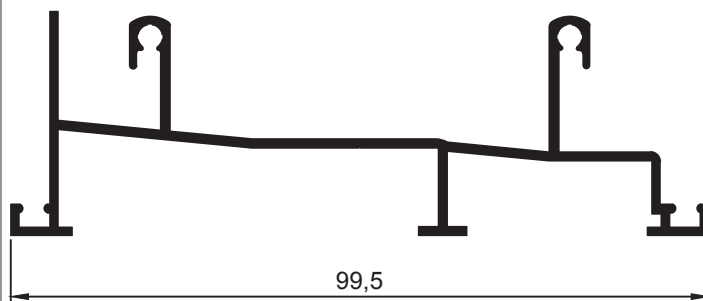

29.45.00 - Perfil Trilho Superior Veneziana Central

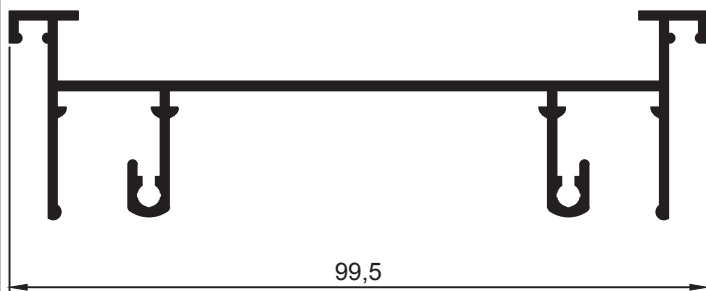

29.59.00 - Perfil Requadro Lateral

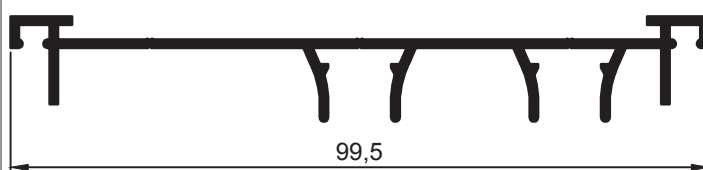

29.60.00 - Perfil Travessa Te

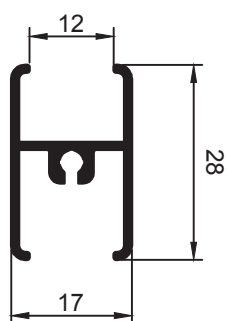

29.11.00 - Perfil Lamina

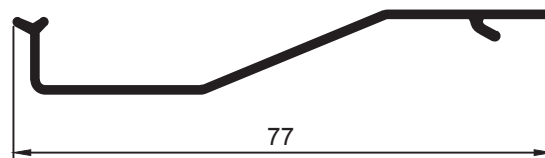

29.20.00 - Perfil Acabamento de Lamina Inferior

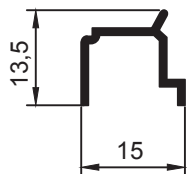

29.36.00 - Perfil Quadrado da Grade

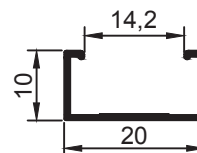

29.47.00 - Perfil Capa Perfil Grade

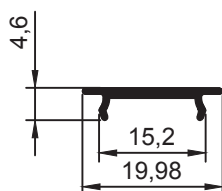

29.50.00 - Perfil Lamina Lambri Porta Abrir

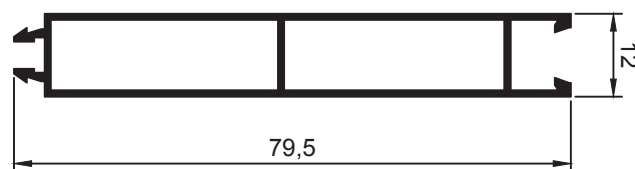

29.51.00 - Perfil Travessa da Lamina Lambri Porta Abrir

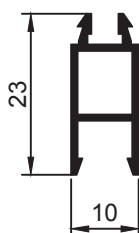

29.52.00 - Perfil Acabamento Lamina

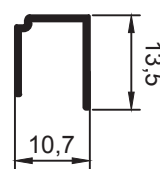

29.57.00 - Perfil Travessa Intermediária Porta Balcão

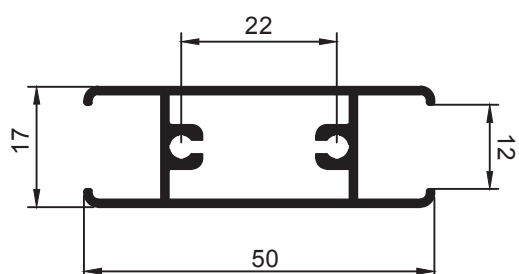

GRUPO 31 • DIVISÓRIA PREMIUM

31.01.00 - Perfil Travessa Vertical

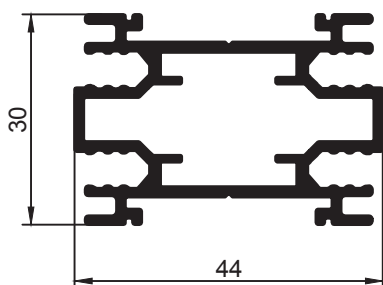

31.02.00 - Perfil Guia Externa Tecnolach

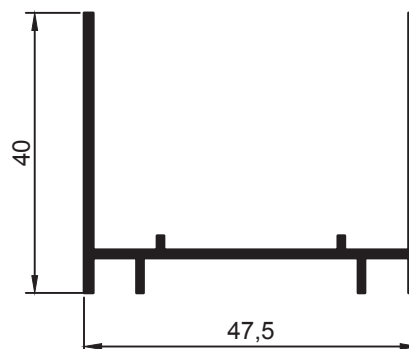

31.03.00 - Perfil Leito Vidro Único Macho

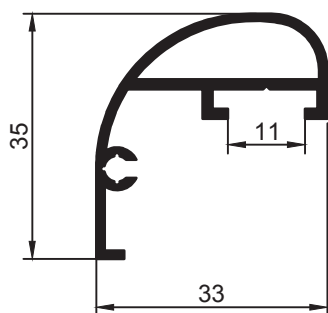

31.04.00 - Perfil Leito Vidro Único Femea

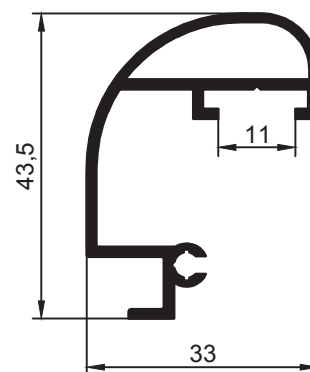

31.05.00 - Perfil Leito Vidro Duplo

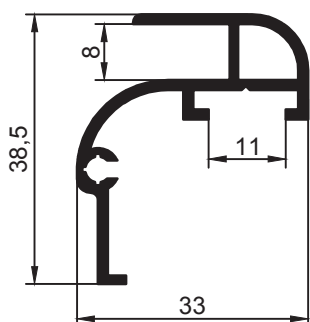

31.06.00 - Perfil Batente

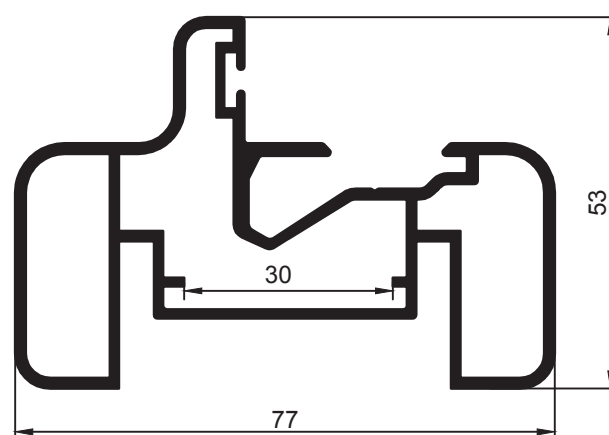

LINHA 31 • DIVISÓRIA PREMIUM

31.08.00 - Perfil Acabamento Frontal

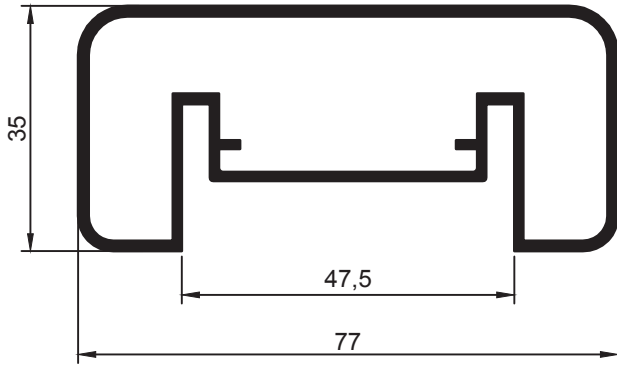

31.09.00 - Perfil Batedeira

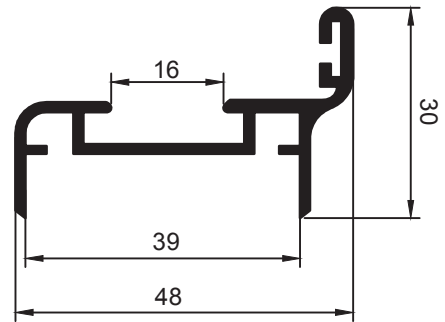

31.10.00 - Perfil Pele de Vidro Duplo

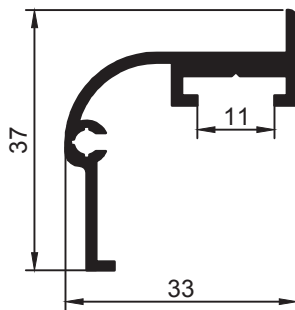

31.11.00 - Perfil de Encaixe

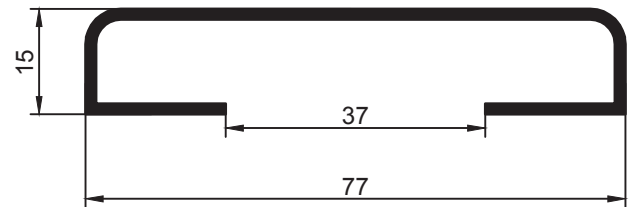

31.12.00 - Perfil De Paginação

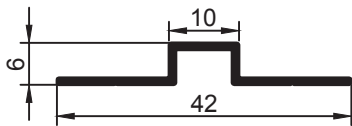

31.13.00 - Perfil Baguete de Acabamento

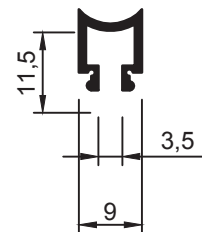

31.16.00 - Perfil Capa do Rodapé

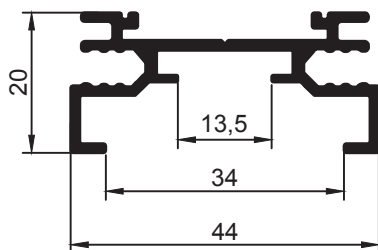

31.17.00 - Perfil Coluna 90°

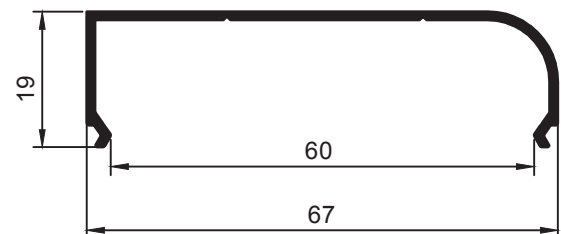

GRUPO 35 • DIVERSOS

35.01.00 - Perfil Airo PVC 01

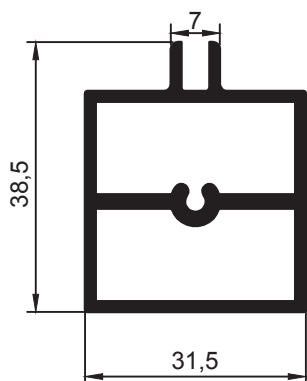

35.02.00 - Perfil Airo PVC 02

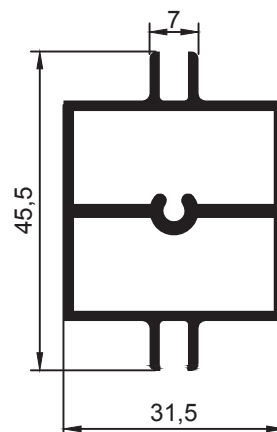

35.03.00 - Perfil Airo PVC 03

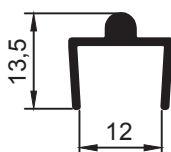

35.04.00 - Perfil Airo PVC 04

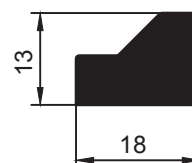

35.05.00 - Perfil Airo PVC 05

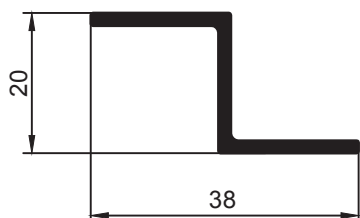

35.06.00 - Perfil Airo PVC 06

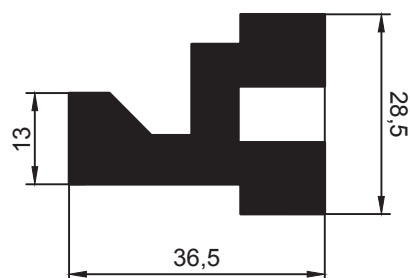

35.07.00 - Perfil Airo PVC 07

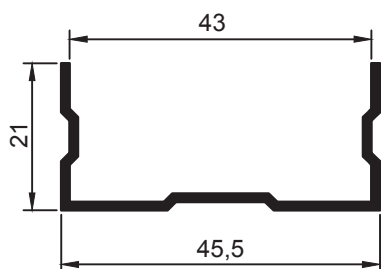

35.08.00 - Perfil Airo PVC 08

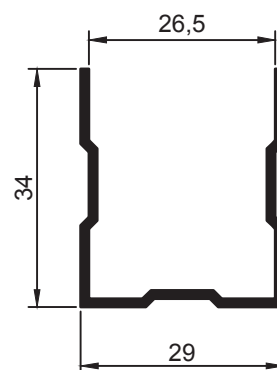

GRUPO 35 • DIVERSOS

35.09.00 - Perfil Airo PVC 09

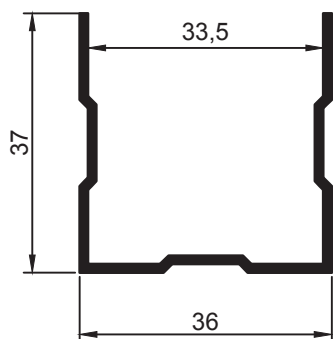

35.10.00 - Perfil Airo PVC 10

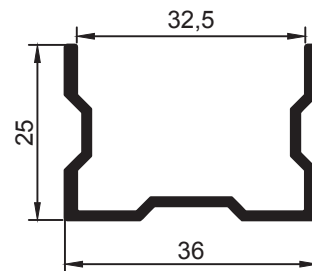

35.11.00 - Perfil Airo PVC 11

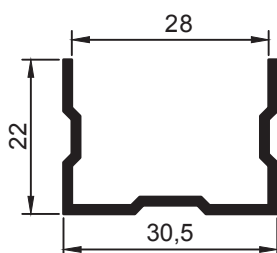

35.12.00 - Perfil Airo PVC 12



35.13.00 - Perfil Inferior Jaba

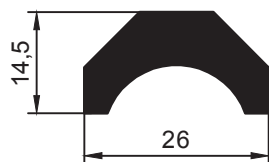

35.14.00 - Perfil Corrimão 01

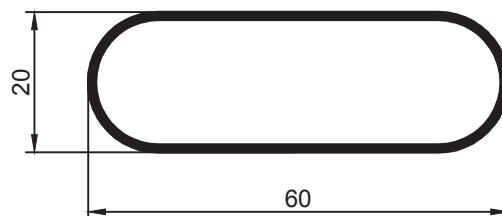

35.15.00 - Perfil Corrimão 02

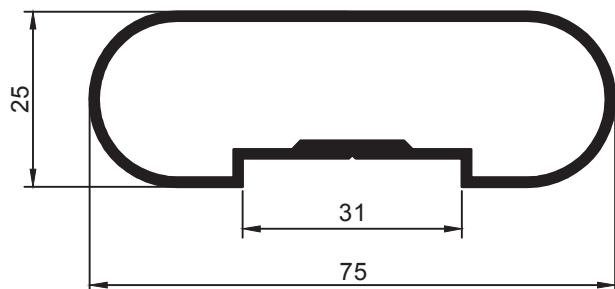

35.16.00 - Perfil Base Corrimão

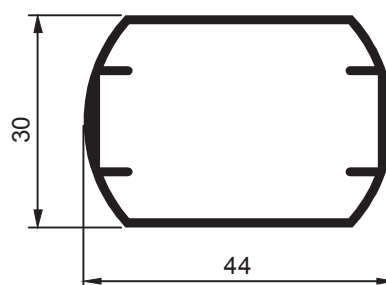

GRUPO 35 • DIVERSOS

35.17.00 - Perfil Tri-Tubular Quadrado Aluv

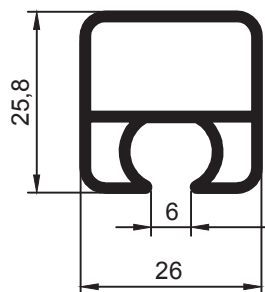

35.18.00 - Perfil Tri-Tubular Retangular Aluv

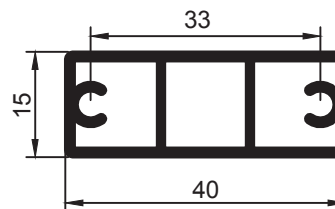

35.19.00 - Perfil Base P/Vidro La Cuisine

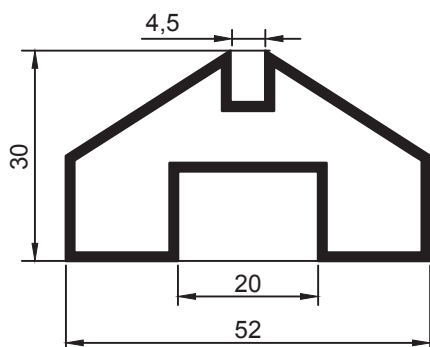

35.20.00 - Perfil Corrimão La Cuisine

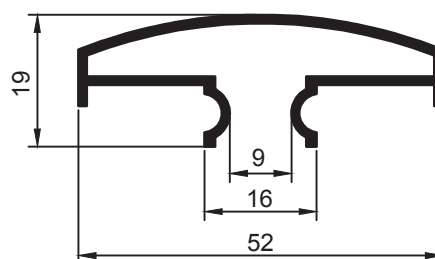

35.21.00 - Perfil Univ 3178

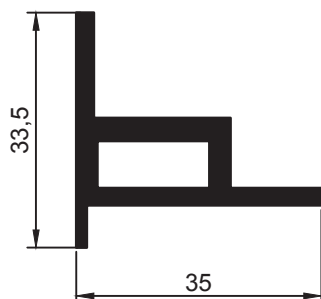

35.22.00 - Perfil de Encaixe P/Rodo

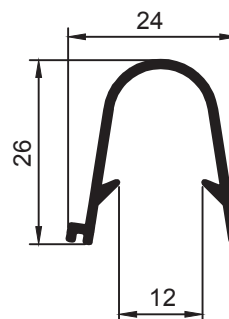

35.23.00 - Perfil Paleta Quebra Vento

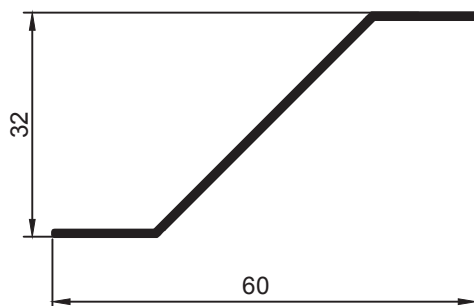

35.24.00 - Perfil Coluna H Quebra Vento

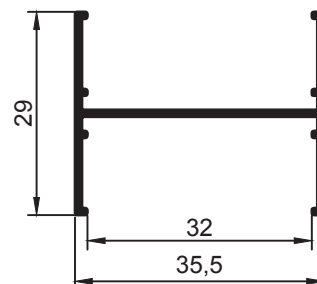

GRUPO 35 • DIVERSOS

35.25.00 - Perfil Guia Lateral Quebra Vento

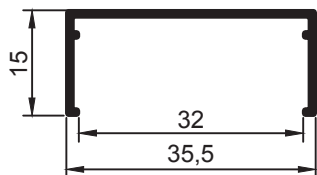

35.26.00 - Perfil Guia Superior e Inferior Quebra Vento

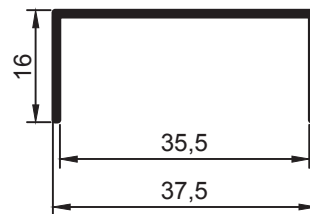

35.29.00 - Perfil Airo P/Vedação de Porta

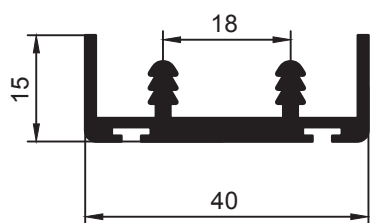

35.35.00 - Perfil Base Quadrada MACIÇA P/Puxador

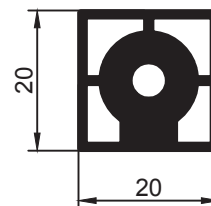

GRUPO 36 • VIDRO TEMPERADO / BOX

36.01.00 - Perfil Inf.P/Vidro Fixo/Correr 8mm

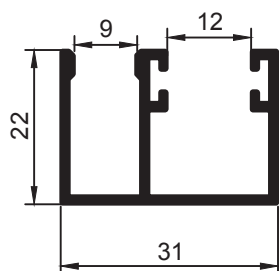

36.02.00 - Perfil Sup.P/Vidro Temp.8mm

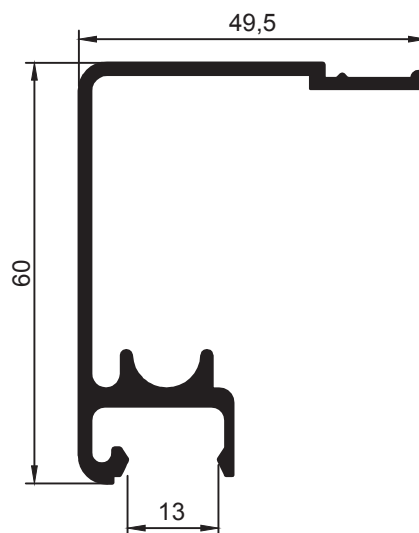

36.03.00 - Perfil Capa Sup.P/Vidro Temp.8mm

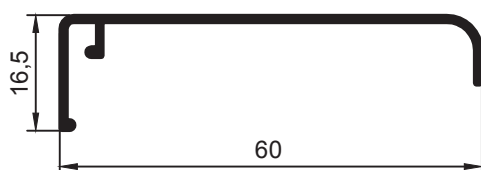

36.04.00 - Perfil Inf.P/Vidro Fixo/Correr 10mm

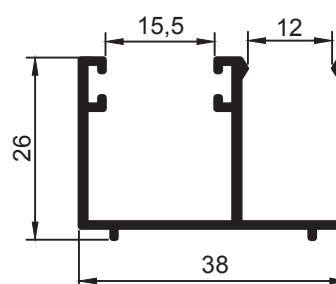

36.05.00 - Perfil Superior P/Box 8mm

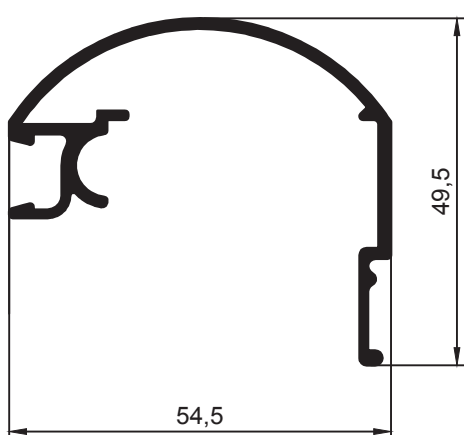

36.06.00 - Perfil Capa Sup. P/Box 8mm

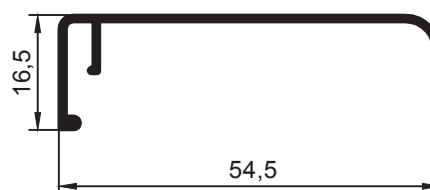

LINHA 36 • VIDRO TEMPERADO / BOX

36.07.00 - Perfil Inferior Leve Box 8mm

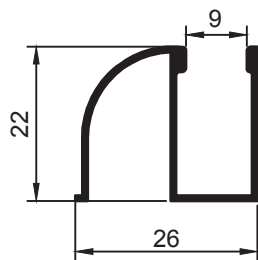

36.08.00 - Perfil Click 8mm Vidro Temperado

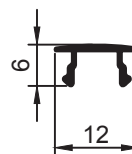

36.09.00 - Perfil Click 10mm Vidro Temperado

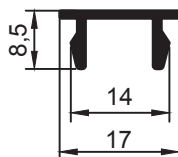

36.10.00 - Perfil U Leve 8mm Vidro

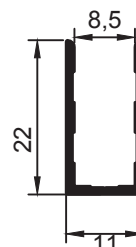

36.11.00 - Perfil U Leve 10mm Vidro

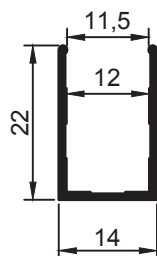

36.12.00 - Perfil U Pesado 8mm Vidro

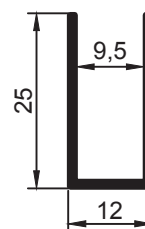

36.13.00 - Perfil U Pesado 10mm Vidro

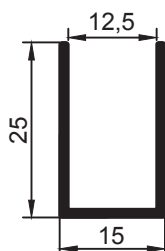

36.14.00 - Perfil Arremate Canto P/Box

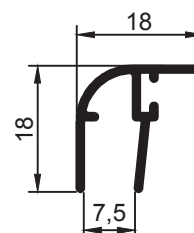

LINHA 36 • VIDRO TEMPERADO / BOX

36.15.00 - Perfil P/Vidro Temperado Mod. 119 I

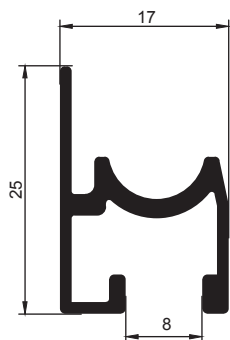

36.16.00 - Perfil P/Vidro Temperado TRU 18x18

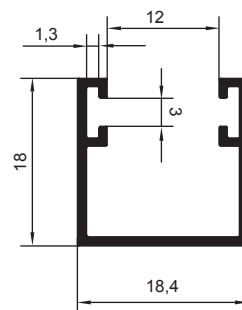

GRUPO 37 • LINHA MODULAR

37.01.00 - Marco Lateral Folha Móvel 3 Folhas

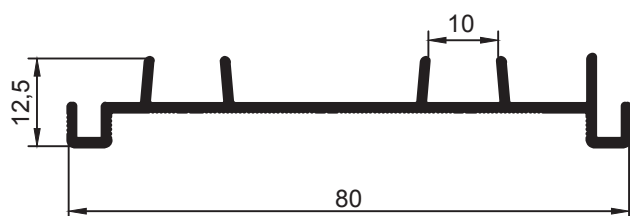

37.02.00 - Marco Lateral Folha Fixa 3 e 6 Folhas

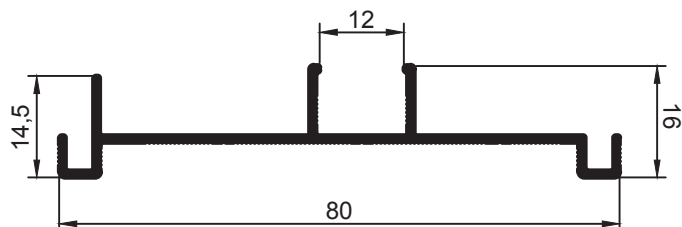

37.03.00 - Marco Lateral Folha Móvel 2 Folhas

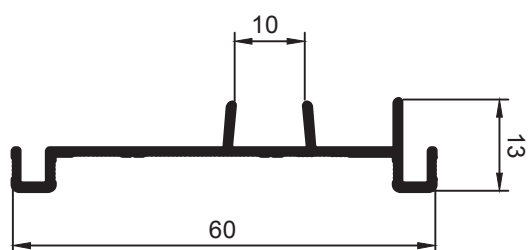

37.04.00 - Marco Lateral Folha Fixa 2 e 4 Folhas

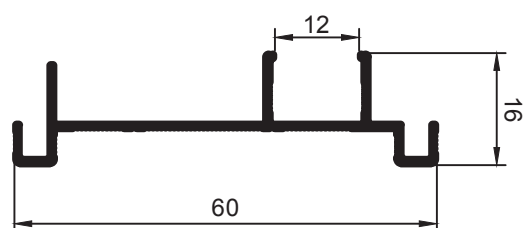

37.05.00 - Trilho Superior/Inferior Peq. 2 e 4 Folhas

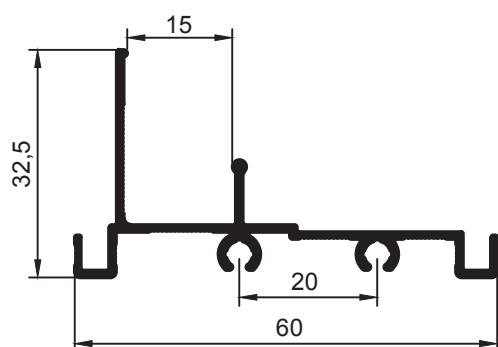

37.06.00 - Trilho Superior/Inferior GR. 2 e 4 Folhas

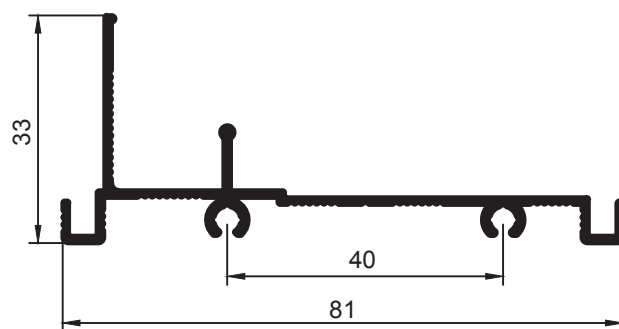

37.07.00 - Trilho Superior/Inferior Peq. 3 e 6 Folhas

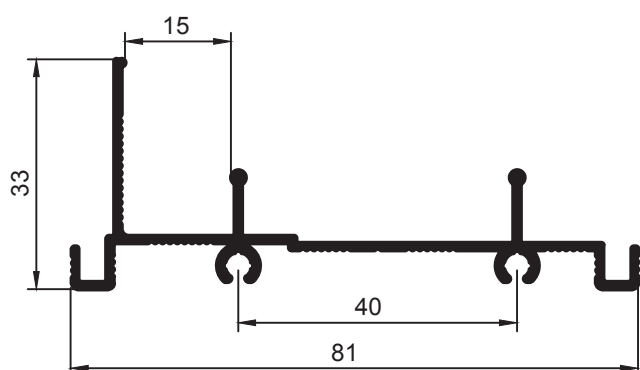

37.08.00 - Perfil Palheta Veneziana

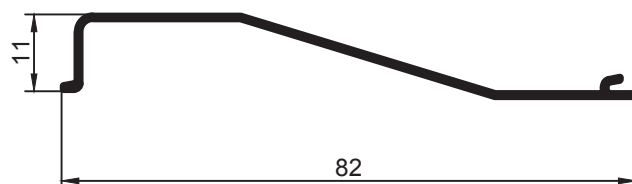

GRUPO 37 • LINHA MODULAR

37.09.00 - Perfil Palheta Fechamento Veneziana

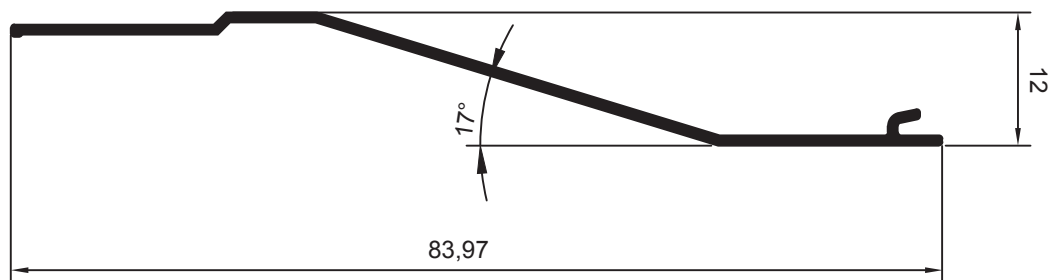

37.10.00 - Perfil Mão Amiga Móvel 2 e 3 Folhas

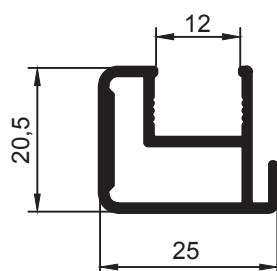

37.11.00 - Perfil Mão Amiga Fixa 3 e 6 Folhas

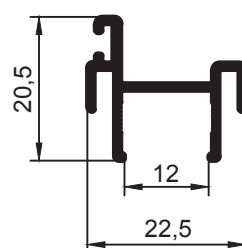

37.12.00 - Perfil Mão Amiga Móvel 4 e 6 Folhas

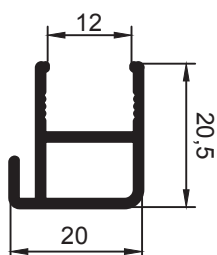

37.13.00 - Perfil Altura Folha Móvel Macho

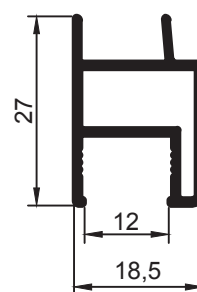

37.14.00 - Perfil Altura Folha Móvel Femea

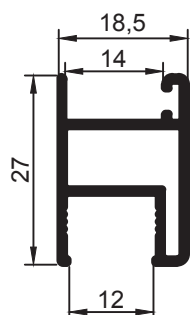

37.15.00 - Perfil Mão Amiga Fixa 2 e 4 Folhas

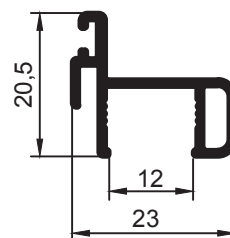

GRUPO 37 • LINHA MODULAR

37.17.00 - Perfil Largura da Folha Fixa

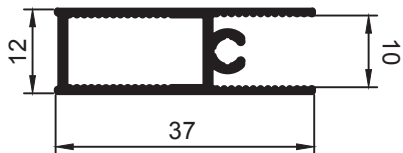

37.16.00 - Perfil Largura da Folha Móvel

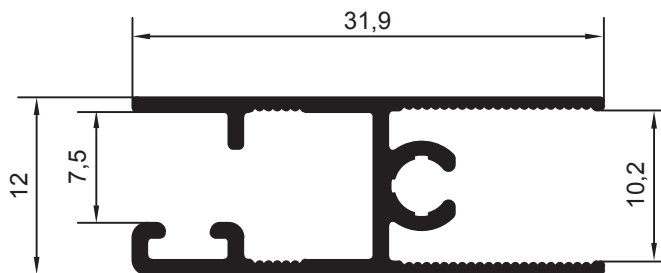



RODINATO[®]
SOLUÇÕES PARA MÓVEIS E ESQUADRIAS

RODINATO[®]
SOLUÇÕES PARA MÓVEIS E ESQUADRIAS

 [rodinato.industriacomercio](https://www.facebook.com/rodinato.industriacomercio)

 [rodinato.com.br](https://www.rodinato.com.br)